



Client _____ Quantity _____
Project _____ Position _____

ROC 700

Model: R70/80BRE/60X/S

Cod: MP01614123003

Technical data

Modularity:	On closed cabinet
Dimension (mm):	800x730x870
Total electric power (kW):	10
Cooking zone dimensions 1 (LxD mm):	fondo vasca 680x397
Nr. Wells:	1
Well litres 1:	60
Well dimensions 1 (mm):	680x397x170
Electric power (V):	380-415
Ampere (A):	15,5
Phases:	3N
Cable section (mmq):	5G2,5
Frequency (Hz):	50-60
Cold water inflow:	3/4"
Cold water pressure (bar):	Max pressure 5 bar
Net volume (m3):	0,508
Packing dimensions (mm):	880x856x1109
Gross weight (kg):	145
Gross volume (m3):	0,835

Features

Working top:	Made of AISI 304 stainless steel with a thickness of 20/10 mm
Material of plate:	Inox
Plate finish:	Smooth
Tipologia ribaltamento:	Manual input
Knobs:	Made of aluminum with IPX5 water protection
Water inflow:	With solenoid valve

Technical draw

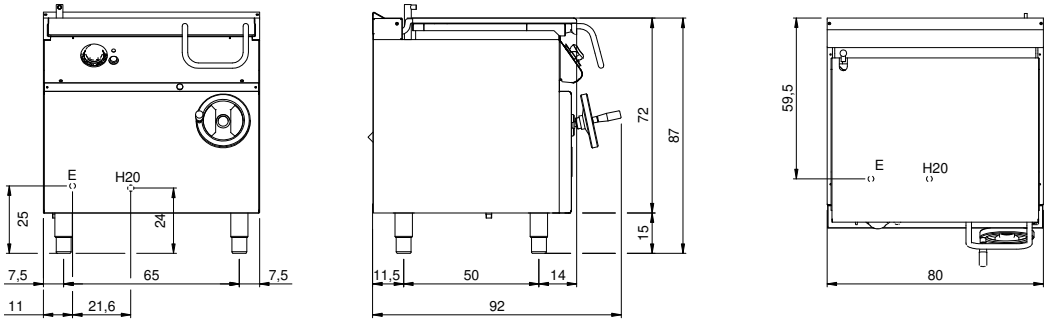

E: Electric power

H2O: Water inflow 3/4"