



Client \_\_\_\_\_ Quantity \_\_\_\_\_  
Project \_\_\_\_\_ Position \_\_\_\_\_

## ROC 1100

Model: R110/40BMFE/P

Cod: MP01575125002

### Technical data

|                                     |                       |
|-------------------------------------|-----------------------|
| Modularity:                         | On cabinet with doors |
| Dimension (mm):                     | 400x1100x870          |
| Total electric power (kW):          | 6,6                   |
| Cooking zone dimensions 1 (LxD mm): | 320x750               |
| Nr. Wells:                          | 1                     |
| Well litres 1:                      | 18                    |
| Well dimensions 1 (mm):             | 320x750x98            |
| Electric power (V):                 | 380-415               |
| Ampere (A):                         | 10,5                  |
| Phases:                             | 3N                    |
| Cable section (mmq):                | 5G1,5                 |
| Frequency (Hz):                     | 50-60                 |
| Net volume (m3):                    | 0,383                 |
| Packing dimensions (mm):            | 480x1272x1240         |
| Gross weight (kg):                  | 92                    |
| Gross volume (m3):                  | 0,757                 |

### Features

|                         |  |
|-------------------------|--|
| Working top:            | Made of AISI 304 stainless steel with a thickness of 2 mm                              |
| Material of plate:      | Chrome   |
| Plate finish:           | Smooth   |
| Tipologia ribaltamento: | Manual input   |
| Knobs:                  | Made of aluminum with IPX5 water protection  |
| Handles:                | The brushed aluminum handles allow for a secure and sturdy grip with a ergonomic lines |
| Heating:                | Armored heating elements positioned under the well                                     |

## Technical draw

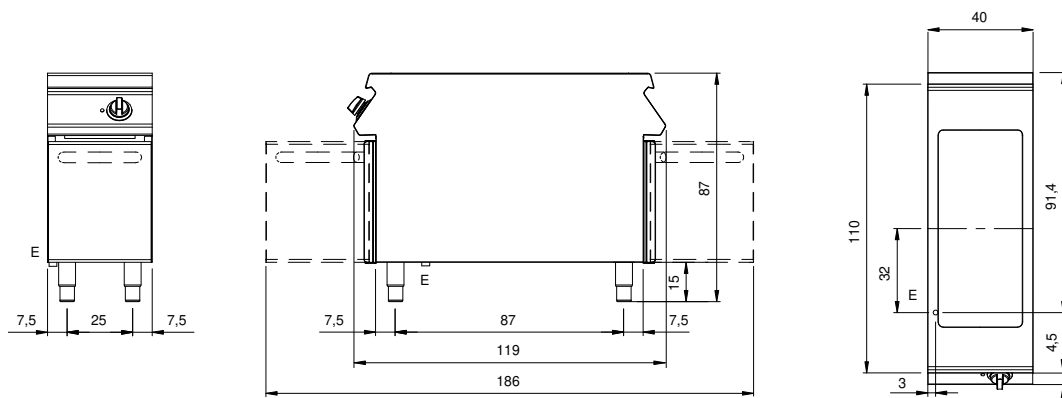

E: Electric power