



Client _____ Quantity _____
 Project _____ Position _____

ROC 900

Model: R90/40BMFE/P

Cod: MP01574124001

Technical data

Modularity:	On cabinet with door
Dimensions (mm):	400x900x870
Total electric power (kW):	4,5
Cooking zone dimensions 1 (LxD mm):	320x480
Nr. Wells:	1
Well litres 1:	11,5
Well dimensions 1 (mm):	320x480x98
Electric power (V):	380-415
Ampere (A):	7
Phases:	3N
Cable section (mmq):	5G1,5
Frequency (Hz):	50-60
Net volume (m3):	0,313
Packing dimensions (mm):	480x1026x1075
Gross weight (kg):	67
Gross volume (m3):	0,529

Features

Working top:	Made of AISI 304 stainless steel with a thickness of 20/10 mm
Material of plate:	Chrome
Plate finish:	Smooth
Tipologia ribaltamento:	Manual input
Knobs:	Made of aluminum with IPX5 water protection
Handles:	The brushed aluminum handles allow for a secure and sturdy grip with a ergonomic lines

Electric multifunction brattpan capacity 13 liters, model on cabinet with door. Side panels, bottom and back made in stainless steel. Top made in AISI 304 thickness 20/10. designed for flush alignment. Rectangular cooking well Dim. 325x530 mm made in stainless steel AISI 304 and rounded edges. Heating by means of Incoloy 800 armored heating elements. Temperature control by means of thermostat. Lamp on control panel to indicate heating activation. Special design knobs to avoid water penetration in the control panel. Base completely made in stainless steel. Pressed hinged door. Ergonomic handle. Adjustable feet made in stainless steel. IPX5 protection rating. Electric power supply VAC 400 3N 50÷60 Hz - 4,5 kW.

Technical draw

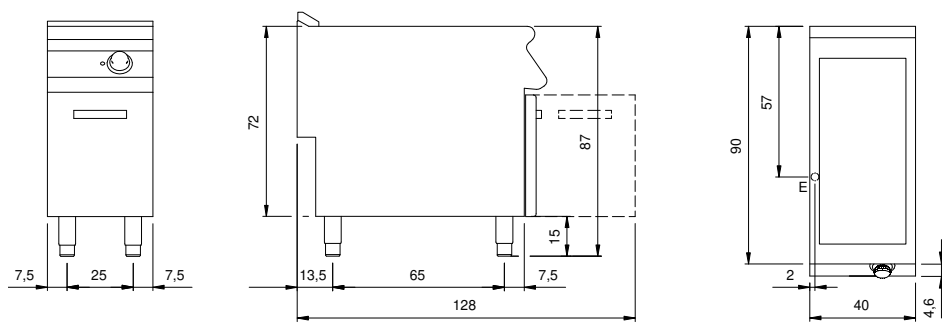

E: Electric power