



Client _____ Quantity _____

Project _____ Position _____

FUN 700

Model: F70/80AGE Market: Extra UE Cod: MP01492123001

Technical data

Modularity:	On cabinet with door
Dimensions (mm):	800x700x850
Total electric power (kW):	12
Cooking zone dimensions 1 (LxD mm):	n°2 681.084.00 (178,5x475)
Cooking zone dimensions 2 (LxD mm):	n°2 681.084.00 (178,5x475)
Electric power (V):	380-415
Ampere (A):	18,5
Phases:	3N
Cable section (mmq):	5G2,5
Frequency (Hz):	50-60
Net volume (m3):	0,48
Packing dimensions (mm):	880x856x1274
Gross weight (kg):	76
Gross volume (m3):	0,960

Features

Grill:	In cast iron
Working top:	Made of AISI 304 stainless steel with a thickness of 10/10 mm
Knobs:	Knobs are made from a sturdy heat-resistant polymer blend and are equipped with liquid anti-leakage washer
Liquid collection container:	In AISI 304 steel, removable
Upright Splash guard:	On three sides

Electric aqua grill on closed cabinet. Side panels, bottom and back made in stainless steel. Top made in AISI 304 thickness 12/10. designed for flush alignment. Reversible cast iron cooking grille. Forward sloping for cooking fatty meats, with 5 mm elements in direct contact and drip tray for collecting grease. Flat for cooking fish and vegetables with circular elements. Side and rear splashback. Grease collection by an upper front extractable tray. An xtractable drawer located under the heating zone contains water whose evaporation ensures grilled food will be tender. Two indipendent cooking zones. Heating by means of Incoloy 800 armored heating elements located under the grille. Temperature control by means of thermostat. Lamp on control panel to indicate oven heating activation. Special design knobs to avoid water penetration in the control panel. Adjustable feet made in stainless steel. Electric power supply VAC 400 3N 50÷60 Hz - 12 kW.

Technical draw

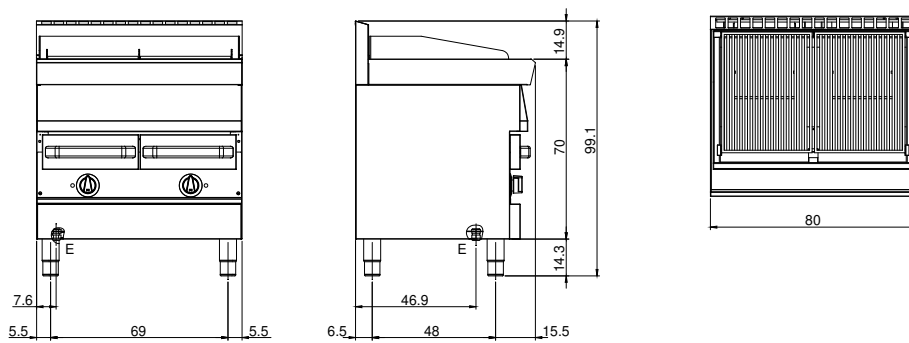

E: Electric power