



Client _____ Quantity _____
Project _____ Position _____

ROC 900

Model: R90/80GRLI/P

Cod: MP01454114016

Technical data

Modularity:	On cabinet with doors
Packing dimensions (mm):	880x1026x1274
Gross weight (kg):	121
Gross volume (m3):	1,150

Features

Grill:	In stainless steel
Working top:	Made of AISI 304 stainless steel with a thickness of 20/10 mm
Knobs:	Made of aluminum with IPX5 water protection
Handles:	The brushed aluminum handles allow for a secure and sturdy grip with a ergonomic lines
Liquid collection container:	Estraibile e lavabile in lavastoviglie
Upright Splash guard:	On three sides
Kit Gas:	Natural gas conversion kit 30/50 m/bar (tested with natural gas G20)

Technical draw

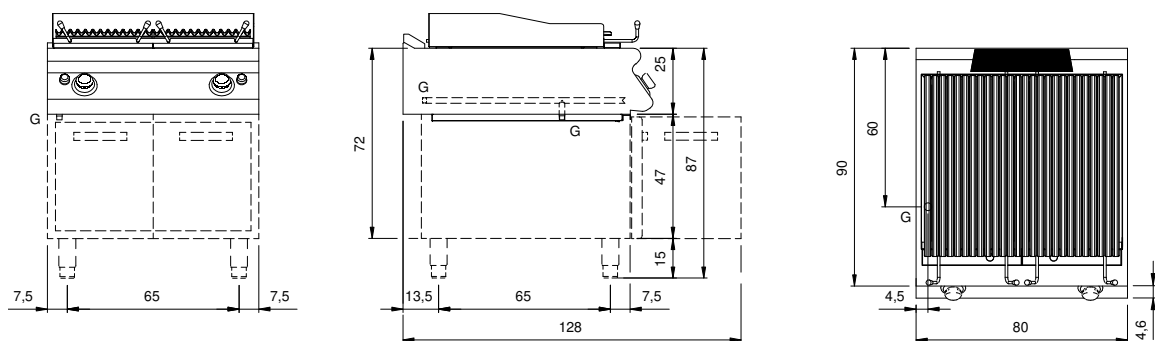

G: Gas connection 1/2"