



Client \_\_\_\_\_ Quantity \_\_\_\_\_  
Project \_\_\_\_\_ Position \_\_\_\_\_

## ROC 900

Model: R90/40GRLG/A  
Market: Extra UE

Cod: MP01454114002

### Technical data

Modularity:	On open cabinet
Dimension (mm):	400x900x870
Packing dimensions (mm):	480x856x1075
Gross weight (kg):	72
Gross volume (m3):	0,442

### Features

Grill:	In cast iron
Working top:	Made of AISI 304 stainless steel with a thickness of 20/10 mm
Knobs:	Made of aluminum with IPX5 water protection
Liquid collection container:	Estraibile e lavabile in lavastoviglie
Upright Splash guard:	On three sides
Kit Gas:	Natural gas conversion kit 30/50 m/bar (tested with natural gas G20)

## Technical draw

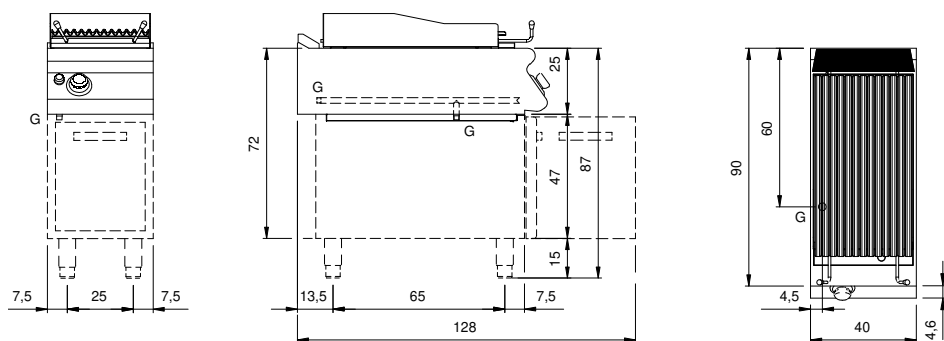

G: Gas connection 1/2"