

Client \_\_\_\_\_ Quantity \_\_\_\_\_

Project \_\_\_\_\_ Position \_\_\_\_\_

**FUN 700**

Model: F70/40GRE/T

Cod: MP01412123004



**Technical data**

Modularity:	Top
Dimensions (mm):	400x700x300
Total electric power (kW):	4,08
Cooking zone dimensions 1 (LxD mm):	265x405
Electric power (V):	380-415
Ampere (A):	6,5
Phases:	3N
Cable section (mmq):	5G1,5
Frequency (Hz):	50-60
Net volume (m3):	0,084
Packing dimensions (mm):	477x776x612
Gross weight (kg):	50
Gross volume (m3):	0,227

**Features**

Working top:	Made of AISI 304 stainless steel with a thickness of 10/10 mm
Knobs:	Knobs are made from a sturdy heat-resistant polymer blend and are equipped with liquid anti-leakage washer

Electric grill FUN 70/40 1 zone 4 kW open cabinet

Technical draw

---

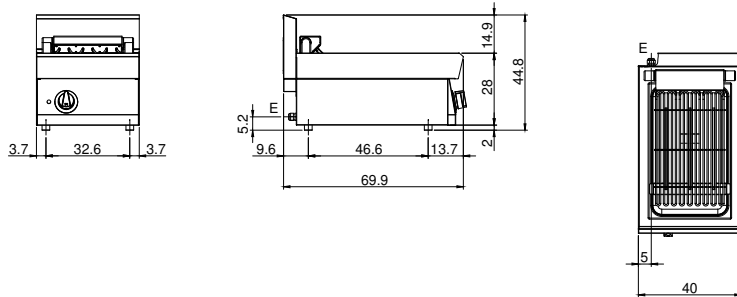

E: Electric power