



Client _____ Quantity _____
Project _____ Position _____

ROC 1100

Model: R110/100FTG/CLR/A

Cod: MP01375115007

Technical data

| | |
|-------------------------------------|-----------------|
| Modularity: | On open cabinet |
| Dimension (mm): | 1000x1100x870 |
| Total gas power (Kcal/h): | 18057 |
| Total gas power (kW): | 21 |
| Cooking zone dimensions 1 (LxD mm): | 734x900 |
| Gas connection: | 1/2" |
| Net volume (m3): | 0,957 |
| Packing dimensions (mm): | 1280x1272x1274 |
| Gross weight (kg): | 212 |
| Gross volume (m3): | 2,074 |

Features

| | |
|------------------------------|--|
| Working top: | Made of AISI 304 stainless steel with a thickness of 2 mm |
| Material of plate: | Polished chrome |
| Knobs: | Made of aluminum with IPX5 water protection |
| Flue: | Made of AISI 304 stainless steel |
| Liquid collection container: | Removable and dishwasher safe |
| Plate: | Polished chromed plate |
| Upright Splash guard: | On two sides (optional) |
| Kit Gas: | Natural gas conversion kit 30/50 m/bar (tested with natural gas G20) |

Gas griddle with 2/3 Smooth 1/3 grooved chromed plate, model on open cabinet. Side panels, bottom and back made of stainless steel. Top made of AISI 304 thickness 20/10. Lateral flue made of stainless steel. Designed for flush alignment. Recessed (4 cm) hotplate fully welded and sealed to the top. Hard chrome plated hotplate with mirror polished surface with cold zone at the front. Round hole and extractable drawer for grease drain and collection. Two independent cooking zones. Heating by means of steel burner with stabilized flame complete with pilot flame and safety thermocouple. Gas supply by means of thermostatic valve. Temperature control by thermostat. Automatic ignition by means of piezoelectric device with waterproof cap. Special design knobs to avoid water penetration in the control panel on both sides. Base completely made of stainless steel. Doors with stainless steel tubular handle. Adjustable feet made of stainless steel. IPX5 protection rating. Gas total power 21 kW.

Technical draw

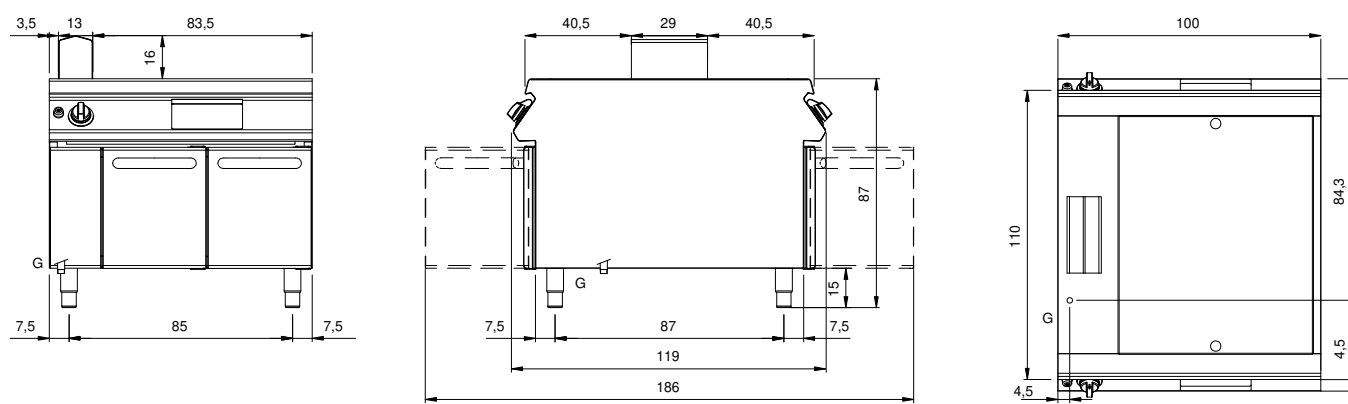

G: Gas connection 1/2"