

Client \_\_\_\_\_ Quantity \_\_\_\_\_  
 Project \_\_\_\_\_ Position \_\_\_\_\_

## ROC 700

Model: R70/40FTE/R/T  
 Market: Extra UE

Cod: MP01374123007



### Technical data

|                                     |             |
|-------------------------------------|-------------|
| Modularity:                         | Top         |
| Dimensions (mm):                    | 400x730x280 |
| Total electric power (kW):          | 5,4         |
| Cooking zone dimensions 1 (LxD mm): | 335x530     |
| Electric power (V):                 | 380-415     |
| Ampere (A):                         | 8,5         |
| Phases:                             | 3N          |
| Cable section (mmq):                | 5G1,5       |
| Frequency (Hz):                     | 50-60       |
| Net volume (m3):                    | 0,082       |
| Packing dimensions (mm):            | 480x856x475 |
| Gross weight (kg):                  | 48,4        |
| Gross volume (m3):                  | 0,195       |

### Features

|                              |   |
|------------------------------|---|
| Working top:                 | Made of AISI 304 stainless steel with a thickness of 20/10 mm |
| Material of plate:           | Mild steel  |
| Plate finish:                | Ribbed  |
| Knobs:                       | Made of aluminum with IPX5 water protection                   |
| Flue:                        | Removable gas exhaust flue grill made of cast iron            |
| Liquid collection container: | Removable and dishwasher safe                                 |
| Plate:                       | In mild steel   |
| Upright Splash guard:        | On two sides (optional)                                       |

Electric griddle with grooved platecounter top model. Side panels, bottom and back made in stainless steel. Top made in AISI 304 thickness 20/10. Rear flue made in enamelled cast-iron. designed for flush alignment. Recessed (4 cm) hotplate fully welded and sealed to the top. Satin cooking surface with cold zone at the front. Round hole and extractable drawer for grease drain and collection. Plate dim.335x530 mm. Plate dim.335x530 mm. Heating by means of Incoloy 800 armored heating elements. Temperature control by means of thermostat. Safety thermostat. Lamp on control panel to indicate heating activation. Special design knobs to avoid water penetration in the control panel. Adjustable feet. IPX5 protection rating. Electric power supply VAC 400 3N 50÷60 Hz - 5,4 kW.

**Technical draw**

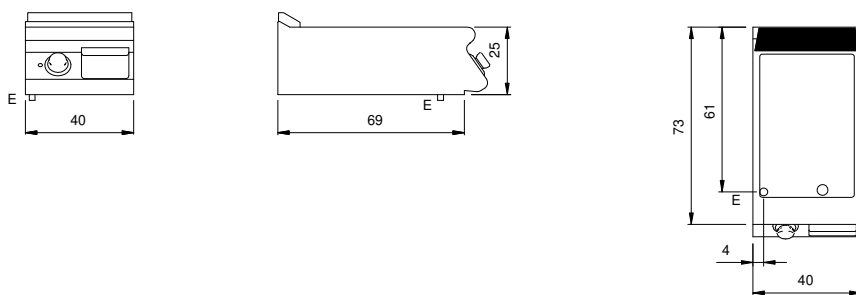

E: Electric power