



Client _____ Quantity _____
Project _____ Position _____

ROC 700

Model: R70/40FTE/L/P
Market: Extra UE

Cod: MP01374123003

Technical data

Modularity:	On cabinet with door
Dimensions (mm):	400x730x870
Total electric power (kW):	5,4
Cooking zone dimensions 1 (LxD mm):	335x530
Electric power (V):	380-415
Ampere (A):	8,5
Phases:	3N
Cable section (mmq):	5G1,5
Frequency (Hz):	50-60
Net volume (m3):	0,254
Packing dimensions (mm):	480x856x1075
Gross weight (kg):	64,6
Gross volume (m3):	0,442

Features

Working top:	Made of AISI 304 stainless steel with a thickness of 20/10 mm
Material of plate:	Mild steel
Plate finish:	Smooth
Knobs:	Made of aluminum with IPX5 water protection
Handles:	The brushed aluminum handles allow for a secure and sturdy grip with a ergonomic lines
Flue:	Removable gas exhaust flue grill made of cast iron
Liquid collection container:	Removable and dishwasher safe
Plate:	In mild steel
Upright Splash guard:	On two sides (optional)

Electric griddle with smooth plate, model on counter with door. Side panels, bottom and back made in stainless steel. Top made in AISI 304 thickness 20/10. Rear flue made in enamelled cast-iron. designed for flush alignment. Recessed (4 cm) hotplate fully welded and sealed to the top. Satin cold zone at the front of the hotplate.. Round hole and extractable drawer for grease drain and collection. Plate dim.335x530 mm. Heating by means of "Incoloy 800" armored heating elements. Temperature control by means of thermostat. Safety thermostat. Lamp on control panel to indicate heating activation. Special design knobs to avoid water penetration in the control panel. Base completely made in stainless steel. Pressed hinged door. Ergonomic handle. Adjustable feet made in stainless steel. IPX5 protection rating. Electric power supply VAC 400 3N 50÷60 Hz - 5.4 kW.

Technical draw

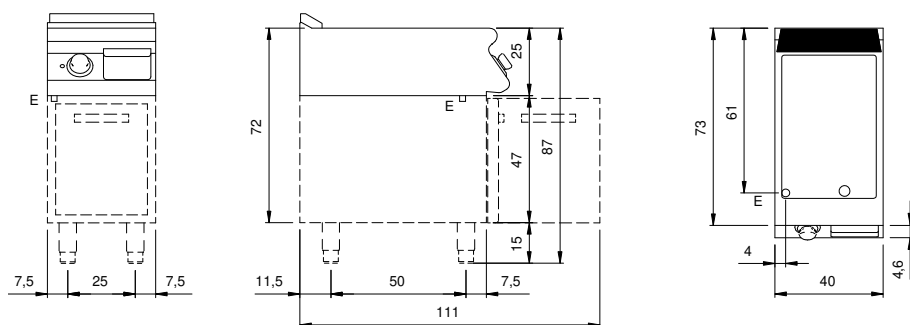

E: Electric power