

Client _____ Quantity _____
Project _____ Position _____

ROC 900

Model: R90/80FTG/L/T
Market: Extra UE

Cod: MP01374114013



Technical data

Modularity:	Top
Dimension (mm):	800x900x280
Total gas power (Kcal/h):	12038
Total gas power (kW):	14
Cooking zone dimensions 1 (LxD mm):	735x700
Gas connection:	1/2"
Net volume (m3):	0,202
Packing dimensions (mm):	880x1026x509
Gross weight (kg):	90
Gross volume (m3):	0,460

Features

Working top:	Made of AISI 304 stainless steel with a thickness of 20/10 mm
Material of plate:	Mild steel
Plate finish:	Smooth
Knobs:	Made of aluminum with IPX5 water protection
Flue:	Removable made of cast iron
Liquid collection container:	Removable and dishwasher safe
Plate:	In mild steel
Upright Splash guard:	On two sides (optional)
Kit Gas:	Natural gas conversion kit 30/50 m/bar (tested with natural gas G20)

Gas griddle with smooth plate, counter top model. Side panels, bottom and back made in stainless steel. Top made in AISI 304 thickness 20/10. Rear flue made in enamelled cast-iron. Designed for flush alignment. Recessed (4 cm) hotplate fully welded and sealed to the top. Satin cold zone at the front of the hotplate. Round hole and extractable drawer for grease drain and collection. Two independent cooking zones. Plate dim. 735x700 mm. Heating by means of steel burner with stabilized flame complete with pilot flame and safety thermocouple. Cooking temperature manually controlled by gas supply safety tap. Automatic ignition by means of piezoelectric device with waterproof cap. Special design knobs to avoid water penetration in the control panel. Adjustable feet. IPX5 protection rating. Gas total power 14 kW.

Technical draw

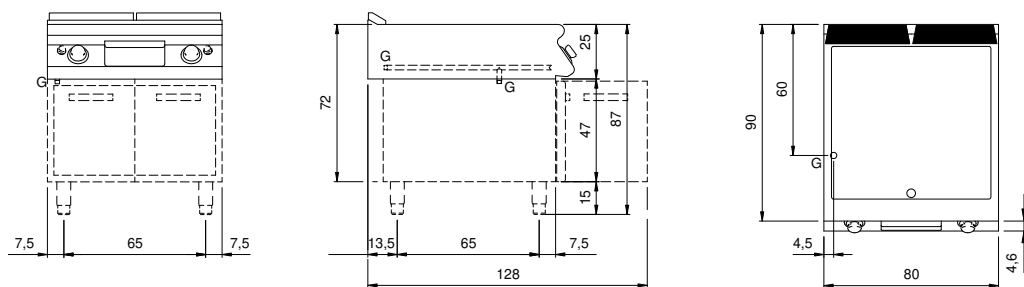

G: Gas connection 1/2"