



Client \_\_\_\_\_ Quantity \_\_\_\_\_  
 Project \_\_\_\_\_ Position \_\_\_\_\_

## ROC 900

Model: R90/40FTG/CR/P

Cod: MP01374114012

### Technical data

Modularity:	On cabinet with door
Dimension (mm):	400x900x870
Total gas power (Kcal/h):	9029
Total gas power (kW):	10,5
Cooking zone dimensions 1 (LxD mm):	335x700
Gas connection:	1/2"
Net volume (m3):	0,313
Packing dimensions (mm):	880x1026x1109
Gross weight (kg):	66,5
Gross volume (m3):	1,001

### Features

Working top:	Made of AISI 304 stainless steel with a thickness of 20/10 mm
Material of plate:	Polished chrome
Plate finish:	Ribbed
Knobs:	Made of aluminum with IPX5 water protection
Handles:	The brushed aluminum handles allow for a secure and sturdy grip with a ergonomic lines
Liquid collection container:	Estraibile e lavabile in lavastoviglie
Plate:	Polished chromed plate
Upright Splash guard:	On two sides (optional)
Kit Gas:	Natural gas conversion kit 30/50 m/bar (tested with natural gas G20)

Technical draw

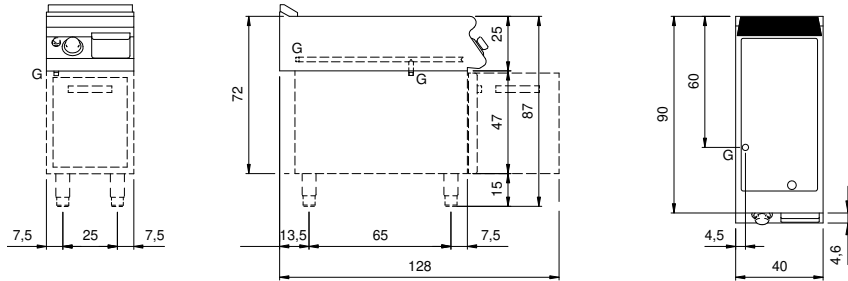

G: Gas connection 1/2"