



Client \_\_\_\_\_ Quantity \_\_\_\_\_  
Project \_\_\_\_\_ Position \_\_\_\_\_

## ROC 700

Model: R70/80FTG/LR/A  
Market: Extra UE

Cod: MP01374113020

### Technical data

|                                     |                 |
|-------------------------------------|-----------------|
| Modularity:                         | On open cabinet |
| Dimension (mm):                     | 800x730x870     |
| Total gas power (Kcal/h):           | 10319           |
| Total gas power (kW):               | 12              |
| Cooking zone dimensions 1 (LxD mm): | 735x530         |
| Gas connection:                     | 1/2"            |
| Net volume (m3):                    | 0,508           |
| Packing dimensions (mm):            | 880x856x1109    |
| Gross weight (kg):                  | 107             |
| Gross volume (m3):                  | 0,835           |

### Features

|                              |                                                                      |
|------------------------------|----------------------------------------------------------------------|
| Working top:                 | Made of AISI 304 stainless steel with a thickness of 20/10 mm        |
| Material of plate:           | Mild steel                                                           |
| Knobs:                       | Made of aluminum with IPX5 water protection                          |
| Flue:                        | Removable gas exhaust flue grill made of cast iron                   |
| Liquid collection container: | Removable and dishwasher safe                                        |
| Plate:                       | In mild steel                                                        |
| Upright Splash guard:        | On two sides (optional)                                              |
| Kit Gas:                     | Natural gas conversion kit 30/50 m/bar (tested with natural gas G20) |

Gas griddle with 2/3 Smooth 1/3 grooved plate, model on open counter. Side panels, bottom and back made in stainless steel. Top made in AISI 304 thickness 20/10. Rear flue made in enamelled cast-iron. designed for flush alignment. Recessed (4 cm) hotplate fully welded and sealed to the top. Satin cold zone at the front of the hotplate.. Round hole and extractable drawer for grease drain and collection. Two independent cooking zones. Plate dim.735x530 mm. Heating by means of steel burner with stabilized flame complete with pilot flame and safety thermocouple. Cooking temperature manually controlled by gas supply safety tap. Automatic ignition by means of piezoelectric device with waterproof cap. Special design knobs to avoid water penetration in the control panel. Base completely made in stainless steel. Adjustable feet made in stainless steel. IPX5 protection rating. Gas total power 12 kW.

## Technical draw

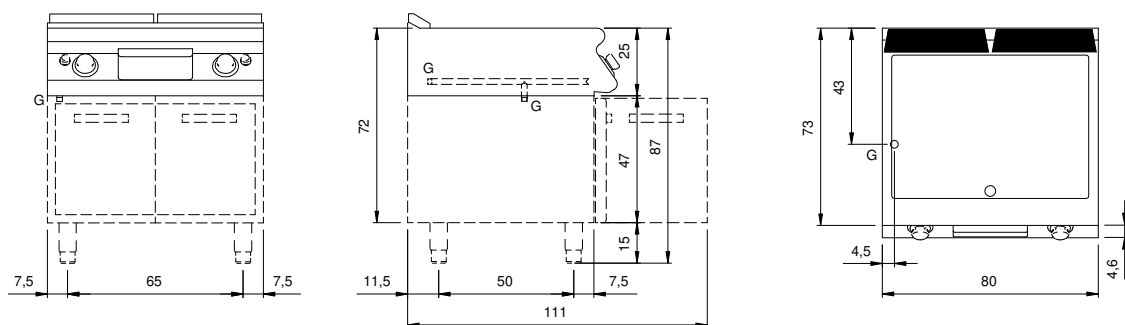

G: Gas connection 1/2"