



Client _____ Quantity _____
Project _____ Position _____

ROC 700

Model: R70/80FTG/CL/P

Cod: MP01374113018

Technical data

| | |
|-------------------------------------|-----------------------|
| Modularity: | On cabinet with doors |
| Dimension (mm): | 800x730x870 |
| Total gas power (Kcal/h): | 12038 |
| Total gas power (kW): | 14 |
| Cooking zone dimensions 1 (LxD mm): | 735x530 |
| Gas connection: | 1/2" |
| Net volume (m3): | 0,508 |
| Packing dimensions (mm): | 880x856x1109 |
| Gross weight (kg): | 113 |
| Gross volume (m3): | 0,835 |

Features

| | |
|------------------------------|--|
| Working top: | Made of AISI 304 stainless steel with a thickness of 20/10 mm |
| Material of plate: | Polished chrome |
| Plate finish: | Smooth |
| Knobs: | Made of aluminum with IPX5 water protection |
| Handles: | The brushed aluminum handles allow for a secure and sturdy grip with a ergonomic lines |
| Flue: | Removable gas exhaust flue grill made of cast iron |
| Liquid collection container: | Estraibile e lavabile in lavastoviglie |
| Plate: | Polished chromed plate |
| Upright Splash guard: | On two sides (optional) |
| Kit Gas: | Natural gas conversion kit 30/50 m/bar (tested with natural gas G20) |

Technical draw

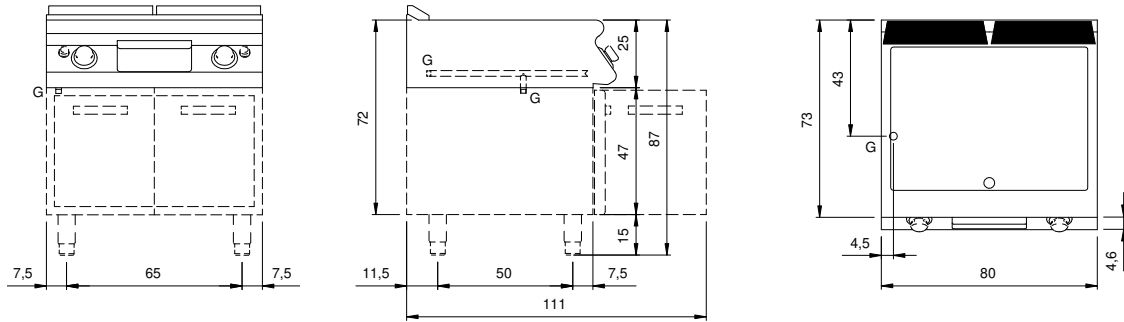

G: Gas connection 1/2"