



Client \_\_\_\_\_ Quantity \_\_\_\_\_  
Project \_\_\_\_\_ Position \_\_\_\_\_

## ROC 700

Model: R70/40FRER/1V17/P

Cod: MP01294123003

### Technical data

Modularity:	On cabinet with door
Dimensions (mm):	400x730x870
Total electric power (kW):	16,5
Nr. Wells:	1
Well litres 1:	17
Well dimensions 1 (mm):	310x345x255
Electric power (V):	380-415
Ampere (A):	25,5
Phases:	3N
Cable section (mmq):	5G4
Frequency (Hz):	50-60
Net volume (m3):	0,508
Packing dimensions (mm):	480x856x1075
Gross weight (kg):	60,6
Gross volume (m3):	0,442

### Features

Working top:	Made of AISI 304 stainless steel with a thickness of 20/10 mm
Type of heating:	Direct
Knobs:	Made of aluminum with IPX5 water protection
Heating:	Rotating heating elements

Electric fryer 1 well 17 liters, model on cabinet with door. Side panels, bottom and back made in stainless steel. Top made in AISI 304 thickness 20/10. designed for flush alignment. Deep pressed well made in stainless steel AISI 304 with radiused edges with front expansion zone for oil collection and cold zone for food particles collection. Heating elements in Stainless steel AISI 304 located inside the well and revolving by 90° for an easy well cleaning. Temperature control by mechanical thermostat. Safety thermostat with manual reset. Lamp on control panel to indicate heating activation. Special design knobs to avoid water penetration in the control panel. Adjustable feet made in stainless steel. IPX5 protection rating. Electric power supply VAC 400 3N 50÷60 Hz - 16,5 kW.

## Technical draw

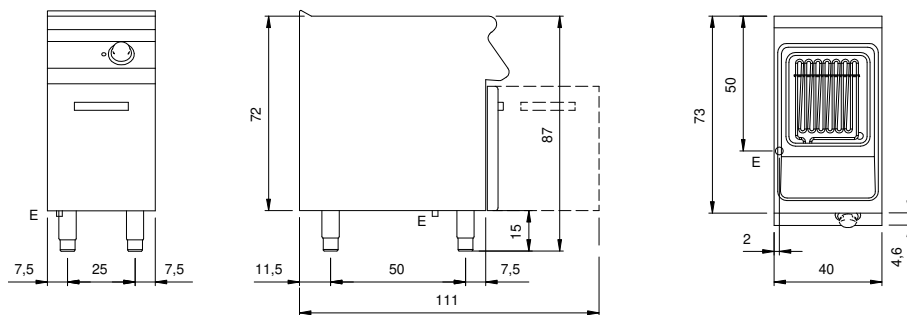

E: Electric power