



Client _____ Quantity _____
Project _____ Position _____

ROC 700

Model: R70/40FRGV/1V13/P

Cod: MP01294113001

Technical data

Modularity:	On cabinet with door
Dimension (mm):	400x730x870
Total gas power (Kcal/h):	10319
Total gas power (kW):	12
Nr. Wells:	1
Well litres 1:	13
Well dimensions 1 (mm):	240x342x318
Gas connection:	1/2"
Net volume (m3):	0,508
Packing dimensions (mm):	480x856x1240
Gross weight (kg):	61,6
Gross volume (m3):	0,509

Features

Working top:	Made of AISI 304 stainless steel with a thickness of 20/10 mm
Type of heating:	Direct
Knobs:	Made of aluminum with IPX5 water protection
Flue:	Removable gas exhaust flue grill made of cast iron
Heating:	Heating pipes in the well
Kit Gas:	Natural gas conversion kit 30/50 m/bar (tested with natural gas G20)

Gas fryer with 1 well 13 liters, model on cabinet with door. Side panels, bottom and back made in stainless steel. Top made in AISI 304 thickness 20/10 designed for flush alignment. Rear flue made in enamelled cast-iron. Deep pressed well with front expansion zone for oil collection and cold zone for food particles collection. Heating by means of high efficiency stainless steel burners located inside the well. Ignition by means of piezoelectric device. Safety thermostat with manual reset. Equipped with 1 basket made of chrome plated steel and thermoplastic handle. Adjustable feet made in stainless steel. IPX5 protection rating. Gas total power 12 kW.

Technical draw

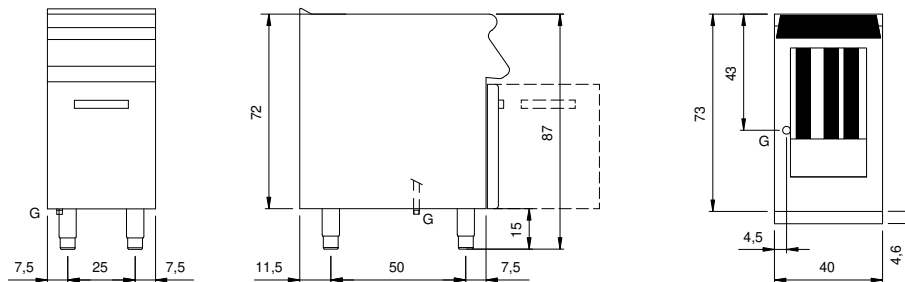

G: Gas connection 1/2"