

Client _____ Quantity _____
Project _____ Position _____

FUN 700

Model: F70/40FRES/1V10/T

Cod: MP01292123004



Technical data

| | |
|----------------------------|-------------|
| Modularity: | Top |
| Dimension (mm): | 400x700x300 |
| Total electric power (kW): | 9 |
| Nr. Wells: | 1 |
| Well litres 1: | 10 |
| Well dimensions 1 (mm): | 244x364x207 |
| Electric power (V): | 380-415 |
| Ampere (A): | 14 |
| Phases: | 3N |
| Cable section (mmq): | 5G2,5 |
| Frequency (Hz): | 50-60 |
| Net volume (m3): | 0,084 |
| Packing dimensions (mm): | 477x776x612 |
| Gross weight (kg): | 34 |
| Gross volume (m3): | 0,227 |

Features

| | |
|------------------|--|
| Working top: | Made of AISI 304 stainless steel with a thickness of 10/10 mm |
| Type of heating: | Direct |
| Knobs: | Knobs are made from a sturdy heat-resistant polymer blend and are equipped with liquid anti-leakage washer |
| Heating: | Tilting heating elements for efficient cleaning |

Electric fryer model top. 1 bowl capacity 10 lt top version. Top and bowl in AISI 304 stainless steel; covering in AISI 304 stainless steel thickness 8/10; external reinforcements made of anti-corrosion material (aluminised sheet metal); bottoms and internal parts in AISI 430 steel; flue cover in enameled steel. Drain valve located in the lower neutral compartment. Equipped with drip tray for collection of residual oil included. Shielded heating elements can be turned over for cleaning, thermostat-controlled in a range of use from 100° to 190°C. Main switch, safety thermostat and indicator light to show correct operation. Vat dimensions: 370x250x210h. mm. Tub capacity 10 lt. - 1 basket with handle in thermoplastic material, 1 vat cover and 1 vat filter included. Total power 9 kW Electrical power supply VAC 400 + 3N 50 Hz.

Technical draw

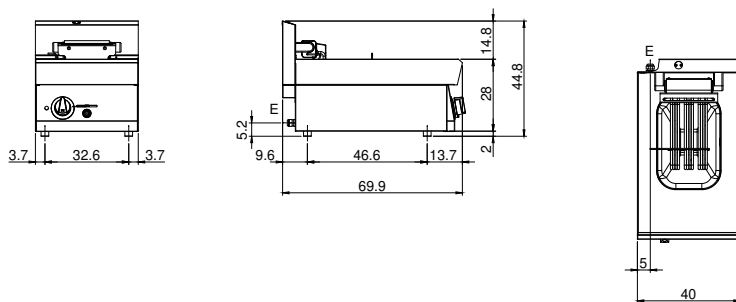

E: Electric power