



Client _____ Quantity _____

Project _____ Position _____

FUN 700

Model: F70/70FRESE/2V10/T

Cod: MP01292123002

Technical data

Modularity:	Top
Dimension (mm):	700x700x300
Total electric power (kW):	15
Nr. Wells:	2
Well litres 1:	10
Well litres 2:	10
Well dimensions 1 (mm):	244x364x207
Well dimensions 2 (mm):	244x364x207
Electric power (V):	380-415
Ampere (A):	23
Phases:	3N
Cable section (mmq):	5G4
Frequency (Hz):	50-60
Net volume (m3):	0,147
Packing dimensions (mm):	776x776x636
Gross weight (kg):	59
Gross volume (m3):	0,383

Features

Working top:	Made of AISI 304 stainless steel with a thickness of 10/10 mm
Type of heating:	Direct
Knobs:	Knobs are made from a sturdy heat-resistant polymer blend and are equipped with liquid anti-leakage washer
Heating:	Tilting heating elements for efficient cleaning

Technical draw

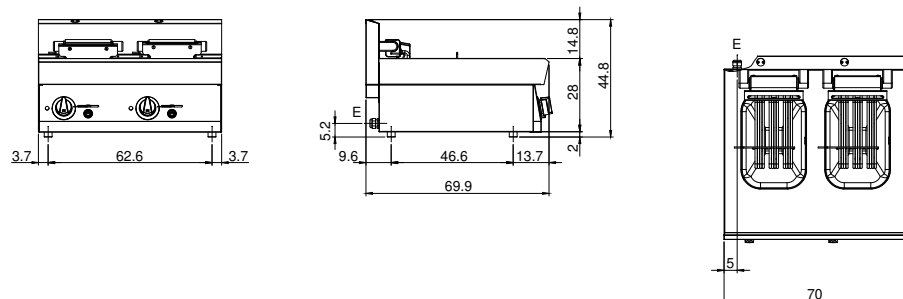

E: Electric power