

Client _____ Quantity _____
 Project _____ Position _____

FUN 700

Model: F70/40FRESE/1V10/T

Cod: MP01292123001



Technical data

Modularity:	Top
Dimensions (mm):	400x700x300
Total electric power (kW):	7,5
Nr. Wells:	1
Well litres 1:	10
Well dimensions 1 (mm):	244x364x207
Electric power (V):	380-415
Ampere (A):	11,5
Phases:	3N
Cable section (mmq):	5G2,5
Frequency (Hz):	50-60
Net volume (m3):	0,084
Packing dimensions (mm):	477x776x612
Gross weight (kg):	34
Gross volume (m3):	0,227

Features

Working top:	Made of AISI 304 stainless steel with a thickness of 10/10 mm
Type of heating:	Direct
Knobs:	Knobs are made from a sturdy heat-resistant polymer blend and are equipped with liquid anti-leakage washer
Heating:	Tilting heating elements for efficient cleaning

Electric Fryer FUN 70/70 2 wells 10 Lt tilting heating elements 18 kW top

Technical draw

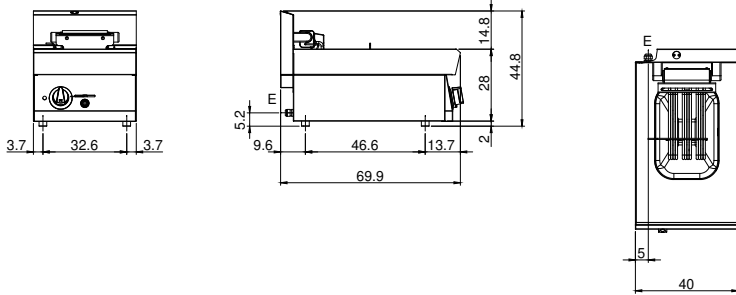

E: Electric power