



Client \_\_\_\_\_ Quantity \_\_\_\_\_  
Project \_\_\_\_\_ Position \_\_\_\_\_

## ROC 1100

Model: R110/80BME/P

Cod: MP01255125004

### Technical data

Modularity:	On cabinet with doors
Dimension (mm):	800x1100x870
Total electric power (kW):	4,4
Nr. Wells:	1
Well litres 1:	52
Well dimensions 1 (mm):	730x685x155
Electric power (V):	380-415
Ampere (A):	10
Phases:	3N
Cable section (mmq):	5G1,5
Frequency (Hz):	50-60
Drain size:	1"
Net volume (m3):	0,766
Packing dimensions (mm):	880x1272x1274
Gross weight (kg):	111
Gross volume (m3):	1,426

### Features

Working top:	Made of AISI 304 stainless steel with a thickness of 2 mm
Knobs:	Made of aluminum with IPX5 water protection
Handles:	The brushed aluminum handles allow for a secure and sturdy grip with a ergonomic lines
Water inflow:	Manual input

Electric bain-marie 2 GN (1/1 + 1/3), model on cabinet with doors. Side panels, bottom and back made of stainless steel. Top made of AISI 304 thickness 20/10 designed for flush alignment. Well made of stainless steel AISI 304. Heating by means of armoured heating elements located under the well. Temperature control by means of thermostat with regulation from 30 °C to 90 °C. Safety thermostat with manual reset which stop heating in case of water lack in the well. Water drain by means of overflow system and vertical drain. Lamp on control panel to indicate heating activation. Special design knob to avoid water penetration in the control panel. Base completely made of stainless steel. Doors with stainless steel tubular handle. Adjustable feet made of stainless steel. IPX5 protection rating. Electric power supply VAC 230 1N 50÷60 Hz - 4,4 kW.

## Technical draw

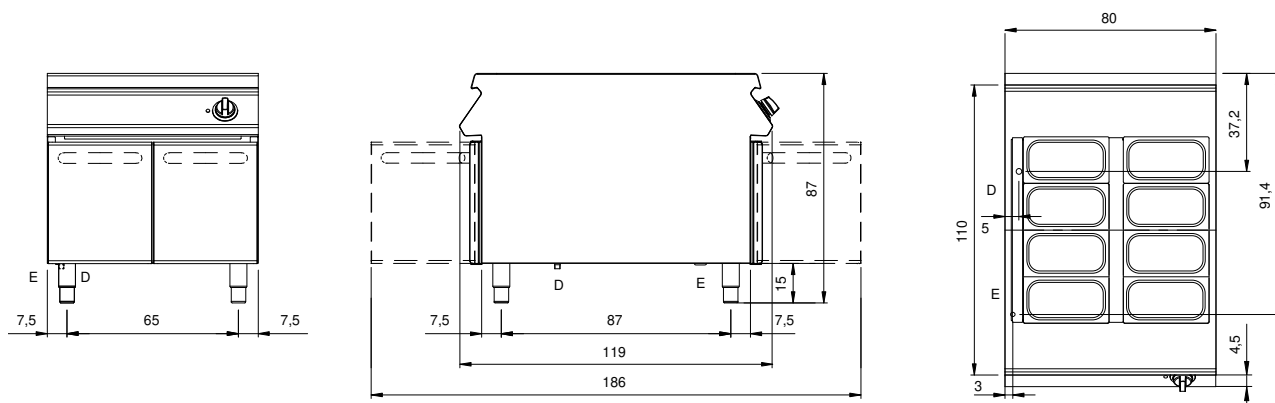

E: Electric power

D: Drain for water