



Client _____ Quantity _____

Project _____ Position _____

ROC 700

Model: R70/80BME/P

Cod: MP01254123005

Technical data

| | |
|----------------------------|-----------------------|
| Modularity: | On cabinet with doors |
| Dimension (mm): | 800x730x870 |
| Total electric power (kW): | 3 |
| Nr. Wells: | 1 |
| Well litres 1: | 39 |
| Well dimensions 1 (mm): | 730x516x155 |
| Electric power (V): | 380-415 |
| Ampere (A): | 5 |
| Phases: | 3N |
| Cable section (mmq): | 5G1,5 |
| Frequency (Hz): | 50-60 |
| Drain size: | 1" |
| Net volume (m3): | 0,508 |
| Packing dimensions (mm): | 880x856x1109 |
| Gross weight (kg): | 91 |
| Gross volume (m3): | 0,835 |

Features

| | |
|---------------|--|
| Working top: | Made of AISI 304 stainless steel with a thickness of 20/10 mm |
| Knobs: | Made of aluminum with IPX5 water protection |
| Handles: | The brushed aluminum handles allow for a secure and sturdy grip with a ergonomic lines |
| Water inflow: | Manual input |

Electric bain-marie 2 GN 1/1, model on counter with doors. Side panels, bottom and back made in stainless steel. Top made in AISI 304 thickness 20/10 designed for flush alignment. Well made in stainless steel AISI 304. Heating by means of armoured heating elements located under the well. Temperature control by means of thermostat with regulation from 30 °C to 90 °C. Safety thermostat with manual reset which stop heating in case of water lack in the well. Water drain by means of overflow system and vertical drain. Lamp on control panel to indicate heating activation. Special design knobs to avoid water penetration in the control panel. Base completely made in stainless steel. Presses hinged doors Ergonomic handles. Adjustable feet made in stainless steel. IPX5 protection rating. Electric power supply VAC 230 1N 50÷60 Hz - 3 kW.

Technical draw

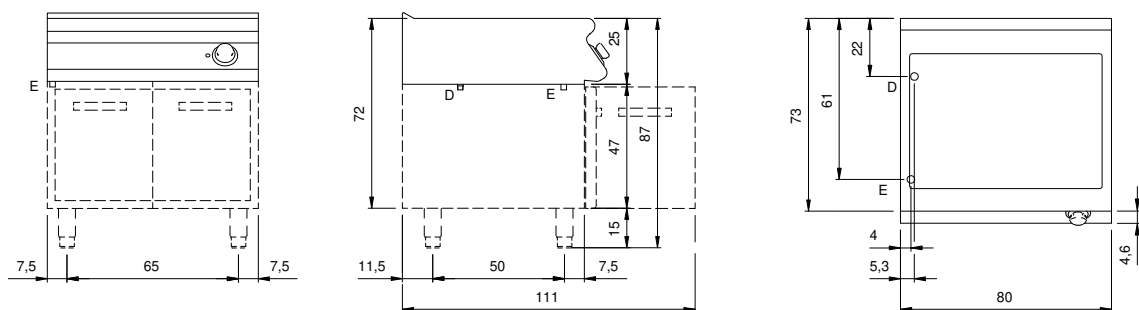

E: Electric power

D: Drain for water