



Client \_\_\_\_\_ Quantity \_\_\_\_\_  
 Project \_\_\_\_\_ Position \_\_\_\_\_

## ROC 700

Model: R70/80BME/A

Cod: MP01254123004

### Technical data

Modularity:	On open cabinet
Dimension (mm):	800x730x870
Total electric power (kW):	3
Nr. Wells:	1
Well litres 1:	39
Well dimensions 1 (mm):	730x516x155
Electric power (V):	380-415
Ampere (A):	5
Phases:	3N
Cable section (mmq):	5G1,5
Frequency (Hz):	50-60
Drain size:	1"
Net volume (m3):	0,508
Packing dimensions (mm):	880x856x1109
Gross weight (kg):	67,6
Gross volume (m3):	0,835

### Features

Working top:	Made of AISI 304 stainless steel with a thickness of 20/10 mm
Knobs:	Made of aluminum with IPX5 water protection
Water inflow:	Manual input

Technical draw

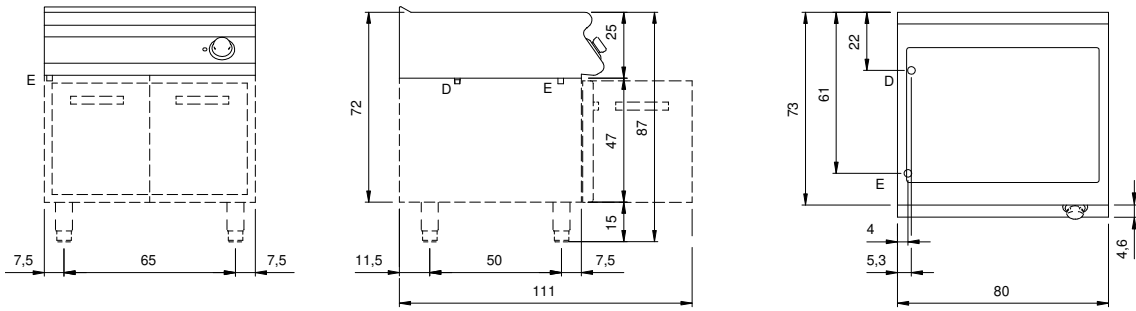

E: Electric power

D: Drain for water