

Client _____ Quantity _____
 Project _____ Position _____

FUN 700

Model: F70/70BME/T

Cod: MP01252123002



Technical data

Modularity:	Top
Dimensions (mm):	700x700x300
Total electric power (kW):	3
Nr. Wells:	1
Well litres 1:	33,5
Well dimensions 1 (mm):	630x510x155
Electric power (V):	380-415
Ampere (A):	5
Phases:	3N
Cable section (mmq):	5G1
Frequency (Hz):	50-60
Drain size:	1/2"
Net volume (m3):	0,147
Packing dimensions (mm):	776x776x636
Gross weight (kg):	37
Gross volume (m3):	0,383

Features

Working top:	Made of AISI 304 stainless steel with a thickness of 10/10 mm
Knobs:	Knobs are made from a sturdy heat-resistant polymer blend and are equipped with liquid anti-leakage washer
Water inflow:	Manual input

Electric bain-marie top version, 1 bowl GN 1/1 h. 15 cm. Top and tub in AISI 304 stainless steel; covering in AISI 304 stainless steel thickness 10/10; external reinforcements made of anti-corrosion material (aluminised sheet metal); bottoms and internal parts in AISI 430 steel. Tub dimensions are GN 1/1 h. 150 mm. Equipped with a control for water drainage by means of ball cock located on the control panel. Heating occurs by means of shielded heating elements which are thermostat controlled in a range of use from 30 to 90°C. Equipped with indicator light to signal proper operation. - 1 false bottom included. - 1 heating element x 1.5 kW. Electrical power supply VAC 230+1 50÷60 Hz. (GN containers not included). Can be set up on bridge system, or on neutral base with optional doors

Technical draw

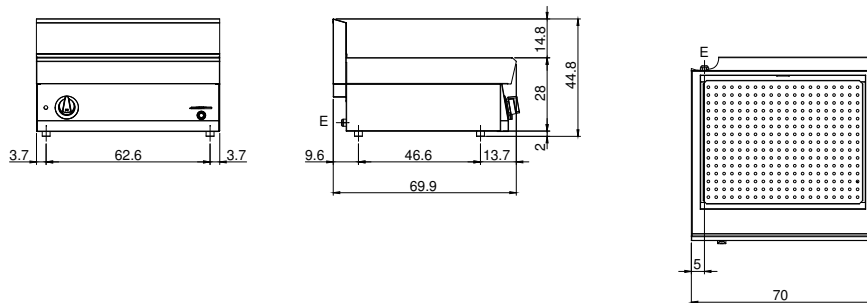

E: Electric power