

Client \_\_\_\_\_ Quantity \_\_\_\_\_

Project \_\_\_\_\_ Position \_\_\_\_\_

## FUN 650

Model: F65/70BME/T

Cod: MP01252122001



### Technical data

Modularity:	Top
Dimension (mm):	700x650x300
Total electric power (kW):	3
Nr. Wells:	1
Well litres 1:	33,5
Well dimensions 1 (mm):	630x510x155
Electric power (V):	380-415
Ampere (A):	5
Phases:	3N
Cable section (mmq):	5G1
Frequency (Hz):	50-60
Drain size:	1/2"
Net volume (m3):	0,137
Packing dimensions (mm):	776x776x636
Gross weight (kg):	33
Gross volume (m3):	0,383

### Features

Working top:	Made of AISI 304 stainless steel with a thickness of 10/10 mm
Knobs:	Knobs are made from a sturdy heat-resistant polymer blend and are equipped with liquid anti-leakage washer
Water inflow:	Manual input

Electric bain marie The top, bowl and false bottom are made of AISI 304 stainless steel. Covering in AISI 304 stainless steel thickness 8/10; bottoms and internal parts in AISI 430 steel; internal reinforcements made of anti-corrosion material (aluminised sheet metal). Bowl size GN 2/1. Suitable for insertion of GN bowls up to h. 150 mm. False bottom included. Tub with front water draining by means of ball cock. Main switch. Thermostat adjustable from 30° to 90° C. Shielded heating elements located outside the tub. Indicator lights to show electrical power supplied and heating elements in operation. 3 heating elements x 1 kW. Total power 3 kW. Electrical power supply VAC 400 + 3N 50÷60 Hz. Bowls not included.

## Technical draw

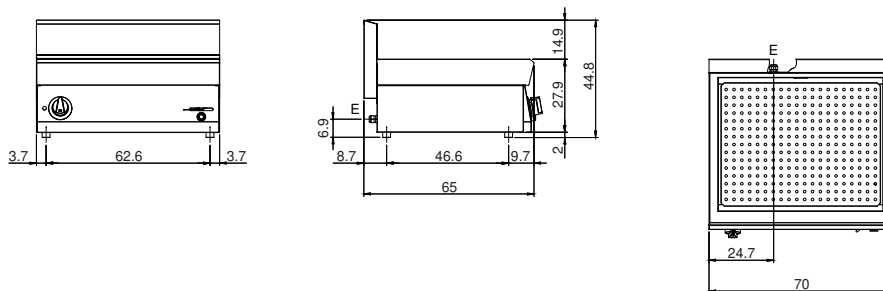

E: Electric power