

Client \_\_\_\_\_ Quantity \_\_\_\_\_

Project \_\_\_\_\_ Position \_\_\_\_\_

## FUN 600

Model: F60/30BME/T

Cod: MP01252121000



### Technical data

Modularity:	Top
Dimension (mm):	300x600x300
Total electric power (kW):	1,5
Nr. Wells:	1
Well litres 1:	15
Well dimensions 1 (mm):	245x467x185
Electric power (V):	220-240
Ampere (A):	7
Phases:	1
Cable section (mmq):	3G1,5
Frequency (Hz):	50-60
Drain size:	1/2"
Net volume (m3):	0,054
Packing dimensions (mm):	376x695x596
Gross weight (kg):	16
Gross volume (m3):	0,156

### Features

Working top:	Made of AISI 304 stainless steel with a thickness of 8/10 mm
Knobs:	Knobs are made from a sturdy heat-resistant polymer blend
Water inflow:	Manual input

Electric bain marie The top, the bowl and the false bottom are made of AISI 304 stainless steel; covering in AISI 430 stainless steel thickness 8/10; bottoms and internal parts in anti-corrosion material (aluminised sheet metal). Tub dimensions are 245x465x150h mm. Equipped with a control for water drainage by means of ball cock located on the control panel. Heating occurs by means of shielded heating elements which are thermostat controlled in a range of use from 30 to 90°C. Equipped with indicator lights to signal proper operation. 1 false bottom included. 1 heating element of 1.5 kW. Total power 1.5 kW Electrical power supply VAC 230+1 50÷60 Hz. Bowls not included.

## Technical draw

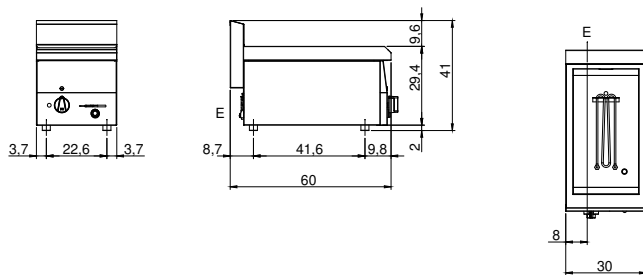

E: Electric power