



Client _____ Quantity _____

Project _____ Position _____

ROC 900

Model: R90/40CPE/1V40/P

Cod: MP01214124001

Technical data

Modularity:	On cabinet with door
Dimension (mm):	400x900x870
Total electric power (kW):	8,5
Nr. Wells:	1
Well litres 1:	40
Well dimensions 1 (mm):	306x508x316
Electric power (V):	380-415
Ampere (A):	13
Phases:	3N
Cable section (mmq):	5G2,5
Frequency (Hz):	50-60
Cold water inflow:	3/4"
Cold water pressure (bar):	Max pressure 5 bar
Drain size:	1"
Net volume (m3):	0,313
Packing dimensions (mm):	480x1026x1075
Gross weight (kg):	56,6
Gross volume (m3):	0,529

Features

Working top:	Made of AISI 304 stainless steel with a thickness of 20/10 mm
Knobs:	Made of aluminum with IPX5 water protection
Water inflow:	With tap

Electric pasta cookers with 1 well capacity 40 liters. Side panels, bottom and back made in stainless steel. Pressed top made in AISI 304 thickness 20/10 with overflow control edge designed for flush alignment. Deep drawn well in AISI 316 polished stainless steel with radiused bottom. Water loading by means of solenoid valve activated by switch on control panel. Pressure switch to stop heating in case the well is empty. Fast filling and top-up options. Fixed water tap in stainless steel located below draining board. Heating by means of revolving armoured immersion-type heating elements. Heating control by means of energy regulator. Lamp on control panel to indicate heating activation. Water drain located inside the lower base. Special design knobs to avoid water penetration in the control panel. Adjustable feet made in stainless steel. Baskets not included. IPX5 protection rating. Electric power supply VAC 400 3N 50÷60 Hz - 8,5 kW.

Technical draw

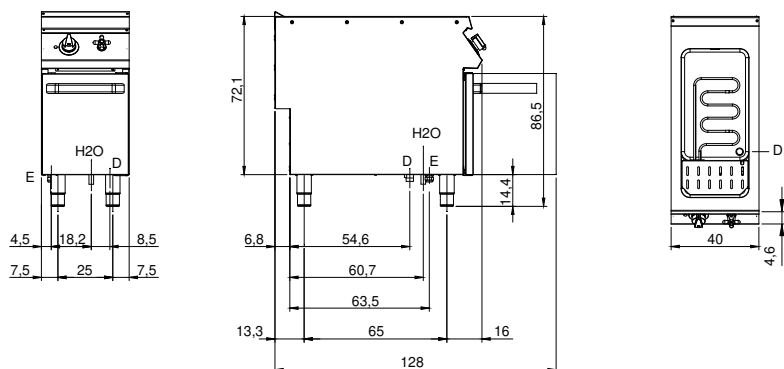

G: Gas connection 1/2"

E: Electric power

D: Drain for water

H2O: Water inflow 3/4"