



Client _____ Quantity _____
Project _____ Position _____

ROC 700

Model: R70/40IND/P

Cod: MP01134123002

Technical data

Modularity:	On cabinet with door
Dimension (mm):	400x730x870
Total electric power (kW):	7
Electric power (V):	380-415
Ampere (A):	11
Phases:	3N
Cable section (mmq):	5G2,5
Frequency (Hz):	50-60
Net volume (m3):	0,254
Packing dimensions (mm):	480x856x1075
Gross weight (kg):	66,6
Gross volume (m3):	0,442

Features

Working top:	Made of AISI 304 stainless steel with a thickness of 20/10 mm
Knobs:	Made of aluminum with IPX5 water protection
Handles:	The brushed aluminum handles allow for a secure and sturdy grip with a ergonomic lines
Flue:	Removable gas exhaust flue grill made of cast iron

Induction hob with 2 cooking zones, model on counter with door. Side panels, bottom and back made in stainless steel. Glass ceramic hob sealed to the top. Top designed for flush alignment. Heating is activated by the pots detection system when they are in contact with the plate equipped with 2 independent cooking zones each with 3.5 kW. Cooking zone marked with a screen printed outline on the glass. Lamps on control panel to indicate heating activation and the proper equipment operation designed for flush alignment. Special design knobs to avoid water penetration in the control panel. Base completely made in stainless steel. Pressed hinged door. Ergonomic handle. Adjustable feet made in stainless steel. IPX5 protection rating. Electric power supply VAC 400 3N 50÷60 Hz - 7 kW.

Technical draw

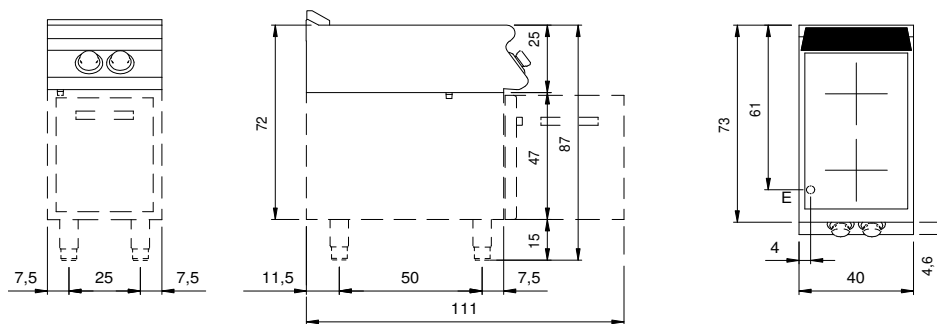

E: Electric power