



Client _____ Quantity _____
Project _____ Position _____

ROC 900

Model: R90/80PVE/P

Cod: MP01094124006

Technical data

Modularity:	On cabinet with doors
Dimension (mm):	800x900x870
Total electric power (kW):	13,6
Electric power (V):	380-415
Ampere (A):	31
Phases:	3N
Cable section (mmq):	5G6
Frequency (Hz):	50-60
Net volume (m3):	0,626
Packing dimensions (mm):	880x1026x1109
Gross weight (kg):	81,1
Gross volume (m3):	1,001

Features

Working top:	Made of AISI 304 stainless steel with a thickness of 20/10 mm
Knobs:	Made of aluminum with IPX5 water protection
Handles:	The brushed aluminum handles allow for a secure and sturdy grip with a ergonomic lines
Flue:	Removable made of cast iron

Glass ceramic hob 4 with cooking zone, model on cabinet with doors. Side panels, bottom and back made in stainless steel. Glass ceramic hob sealed to the top with 4 independent cooking zone each equipped with a 3 kW radiating element diam.300 mm. and relevant energy regulator. tp designed for flush alignment. Cooking zone marked with a screen printed outline on the glass. Lamps on control panel to indicate heating activation and the proper equipment operation. Special design knobs to avoid water penetration in the control panel.IPX5 protection rating. Base completely made in stainless steel. Presses hinged doors Ergonomic handles. Adjustable feet made in stainless steel. Electric power supply VAC 400 3N 50÷60 Hz - 13,6 kW.

Technical draw

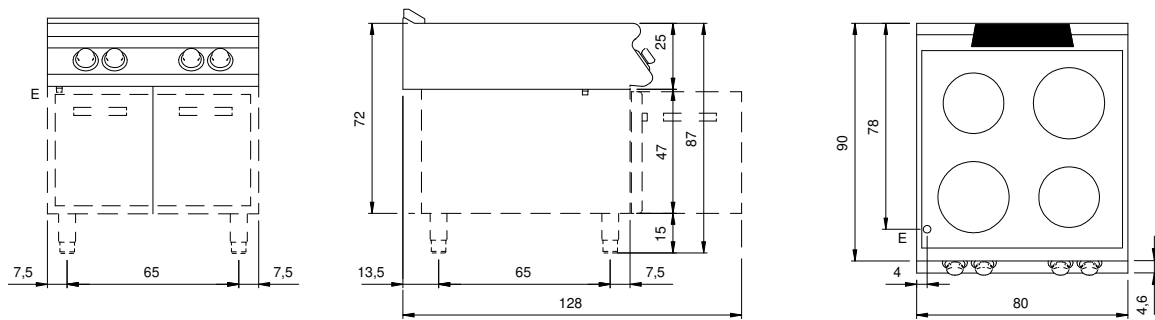

E: Electric power