



Client \_\_\_\_\_ Quantity \_\_\_\_\_  
 Project \_\_\_\_\_ Position \_\_\_\_\_

## FUN 700

Model: F70/40PVE/A

Cod: MP01092123001

### Technical data

Modularity:	On open cabinet
Dimensions (mm):	400x700x850
Total electric power (kW):	5
Electric power (V):	380-415
Ampere (A):	11,5
Phases:	3N
Cable section (mmq):	5G2,5
Frequency (Hz):	50-60
Net volume (m3):	0,238
Packing dimensions (mm):	477x776x1147
Gross weight (kg):	32
Gross volume (m3):	0,425

### Features

Working top:	Made of AISI 304 stainless steel with a thickness of 10/10 mm
Knobs:	Knobs are made from a sturdy heat-resistant polymer blend and are equipped with liquid anti-leakage washer

Glass ceramic hob 4 with cooking zone, model on open cabinet. Side panels, bottom and back made in stainless steel. Glass ceramic hob sealed to the top with 4 independent cooking zone each equipped with a 3 kW radiating element diam.300 mm. and relevant energy regulator. Top designed for flush alignment. Cooking zone marked with a screen printed outline on the glass. Lamps on control panel to indicate heating activation and the proper equipment operation. Special design knobs to avoid water penetration in the control panel. IPX5 protection rating. Base completely made in stainless steel. Adjustable feet made in stainless steel. Electric power supply VAC 400 3N 50÷60 Hz - 13,6 kW.

**Technical draw**

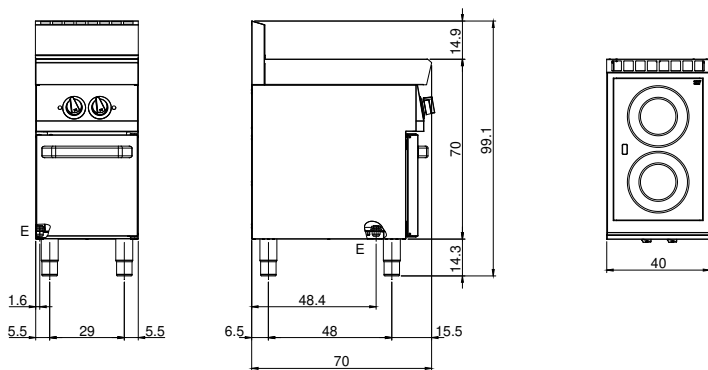

E: Electric power