



Client \_\_\_\_\_ Quantity \_\_\_\_\_

Project \_\_\_\_\_ Position \_\_\_\_\_

## ROC 1100

Model: R110/100TPFE

Cod: MP01055125050

### Technical data

Modularity:	Electric oven
Dimension (mm):	1000x1100x870
Oven dimension (mm):	555x1015x255
Total electric power (kW):	22,6
Oven type:	Static oven
Oven power (kW):	9
Oven temperature range (°C):	50-300
Electric power (V):	380-415
Ampere (A):	44,5
Phases:	3N
Cable section (mmq):	5G10
Frequency (Hz):	50-60
Drain size:	1"
Net volume (m3):	0,957
Packing dimensions (mm):	1280x1272x1274
Gross weight (kg):	210
Gross volume (m3):	2,074

### Features

Working top:	Made of AISI 304 stainless steel with a thickness of 2 mm
Knobs:	Made of aluminum with IPX5 water protection
Handles:	The brushed aluminum handles allow for a secure and sturdy grip with a ergonomic lines
Flue:	Made of AISI 304 stainless steel

Electric solid top with 4 zones on electric static oven. Side panels, bottom and back made of stainless steel. Top made of AISI 304 thickness 20/10 with control edge for liquid collection. Lateral flue made of stainless steel, designed for flush alignment. Cooking plate made with high thick steel 16M06. 4 independent cooking zones each with 3.4 kW power, marked with a satin cooking surface. Safety thermosat with automatic recovery. Lamp to indicate heating activation and proper working of the equipment. Electric oven GN 2/1. Heating by electric upper and lower heating elements with independent regulation. Temperature regulation by thermostat, from 50 °C to 300 °C. Safety thermostat. Lamp on control panel to indicate oven heating activation. Cooking chamber made of stainless steel. Oven inner door made of stainless steel with labyrinth seal. Oven power 9 kW. Door with stainless steel tubular handle. Special design knobs to avoid water penetration in the control panel on both sides. IPX5 protection rating. Adjustable feet made of stainless steel. Electric power supply VAC 400 3N 50÷60 Hz - 22,6 kW.

## Technical draw

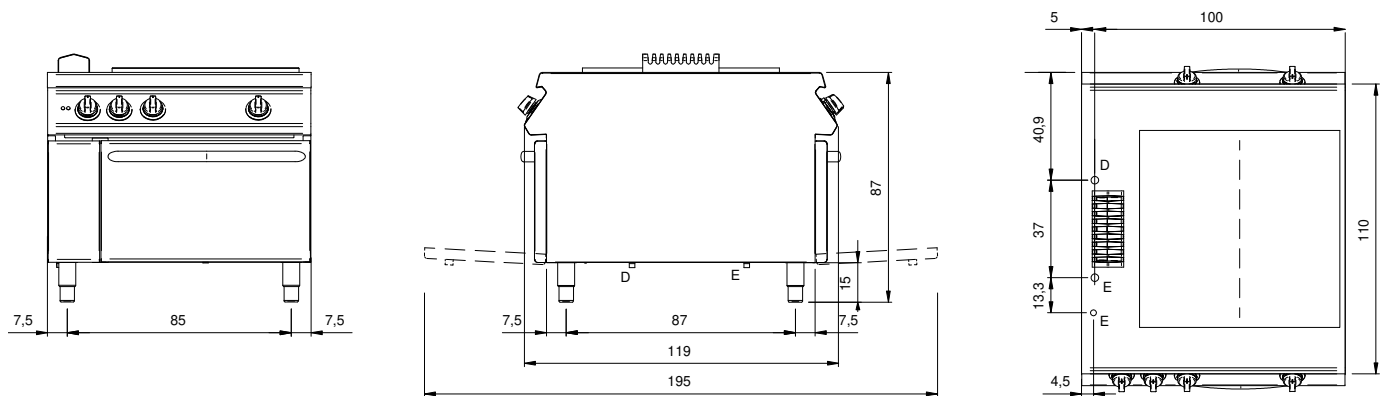

E: Electric power