



Client \_\_\_\_\_ Quantity \_\_\_\_\_  
Project \_\_\_\_\_ Position \_\_\_\_\_

## ROC 900

Model: R90/80TPFEV

Cod: MP01054124031

### Technical data

Modularity:	Electric oven
Dimension (mm):	800x900x870
Oven dimension (mm):	555x655x255
Total electric power (kW):	19,6
Oven type:	Electric convection oven
Oven power (kW):	6
Oven temperature range (°C):	95-300
Electric power (V):	380-415
Ampere (A):	31
Phases:	3N
Cable section (mmq):	5G6
Frequency (Hz):	50-60
Drain size:	1"
Net volume (m3):	0,626
Packing dimensions (mm):	880x1026x1109
Gross weight (kg):	181
Gross volume (m3):	1,001

### Features

Working top:	Made of AISI 304 stainless steel with a thickness of 20/10 mm
Knobs:	Made of aluminum with IPX5 water protection
Handles:	The brushed aluminum handles allow for a secure and sturdy grip with a ergonomic lines
Flue:	Removable made of cast iron

Technical draw

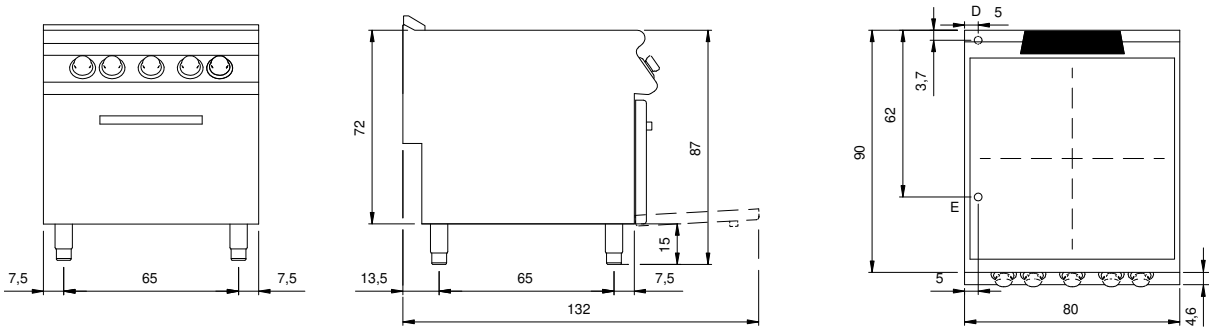

E: Electric power