



Client _____ Quantity _____
Project _____ Position _____

ROC 700

Model: R70/120TPFG

Cod: MP01054113005

Technical data

Modularity:	On cabinet with door
Dimension (mm):	1200x730x870
Oven dimension (mm):	555x660x289
Total gas power (Kcal/h):	24936
Total gas power (kW):	29
Whole-plate power gas (kW):	9
Oven type:	Static oven
Oven power (kW):	8
Oven temperature range (°C):	95-300
Gas connection:	1/2"
Net volume (m3):	0,762
Packing dimensions (mm):	1280x856x1109
Gross weight (kg):	175
Burner power 3 (kW):	6
Burner power 4 (kW):	6
Gross volume (m3):	1,215

Features

Working top:	Made of AISI 304 stainless steel with a thickness of 20/10 mm
Knobs:	Made of aluminum with IPX5 water protection
Handles:	The brushed aluminum handles allow for a secure and sturdy grip with a ergonomic lines
Flue:	Removable gas exhaust flue grill made of cast iron
Kit Gas:	Natural gas conversion kit 30/50 m/bar (tested with natural gas G20)

Technical draw

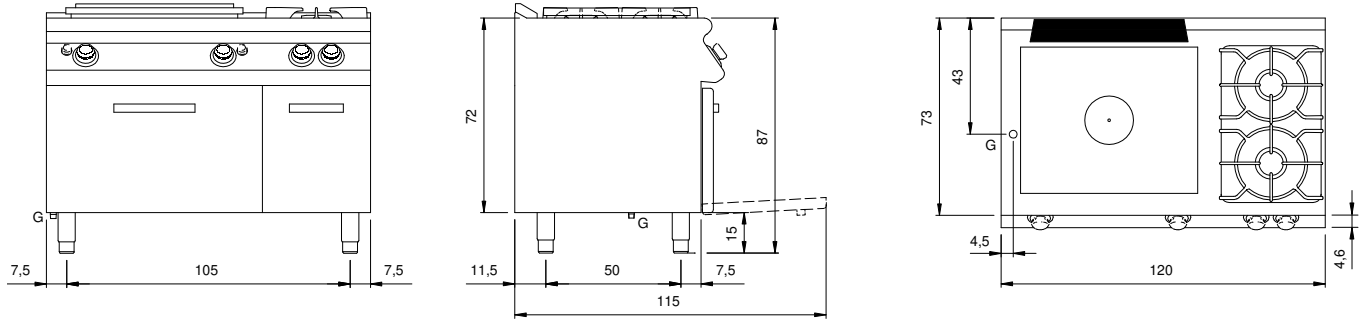

G: Gas connection 1/2"