



Client \_\_\_\_\_ Quantity \_\_\_\_\_  
 Project \_\_\_\_\_ Position \_\_\_\_\_

## FUN 700

Model: F70/80TPE/P

Cod: MP01052123003

### Technical data

Modularity:	On cabinet with doors
Dimensions (mm):	800x700x850
Total electric power (kW):	10
Electric power (V):	380-415
Ampere (A):	23
Phases:	3N
Cable section (mmq):	5G4
Frequency (Hz):	50-60
Drain size:	1"
Net volume (m3):	0,48
Packing dimensions (mm):	880x856x1274
Gross weight (kg):	132
Gross volume (m3):	0,960

### Features

Working top:	Made of AISI 304 stainless steel with a thickness of 10/10 mm
Knobs:	Knobs are made from a sturdy heat-resistant polymer blend and are equipped with liquid anti-leakage washer
Handles:	Brushed aluminum finish

Gas solid top range with 2 gas boiling unit top. Top in AISI 304 stainless steel thickness 10/10; covering in AISI 304 stainless steel thickness 10/10; bottoms and internal parts in AISI 430 steel; internal reinforcements made of anti-corrosion material (aluminised sheet metal). Full plate in steel featuring high-performance differentiated thermal zones and equipped with extractable central ring. Heating takes place by means of the high-power cast iron central burner, with piezoelectric ignition pilot burner. Gas is supplied by means of a thermocouple safety valve. Hob with two high-power cast iron/brass rapid burners with pilot burner for automatic ignition. Gas is supplied by means of a safety valve with thermocouple. The enamelled steel bowl can easily be extracted for cleaning. The hob pan support is made of anti-acid enamelled cast iron. Full plate 1 burner 5.5 kW. Gas hob 2 burners 1 burner x 3.7 kW and 1 x 5.5 kW. Total gas power 14.7 kW.

**Technical draw**

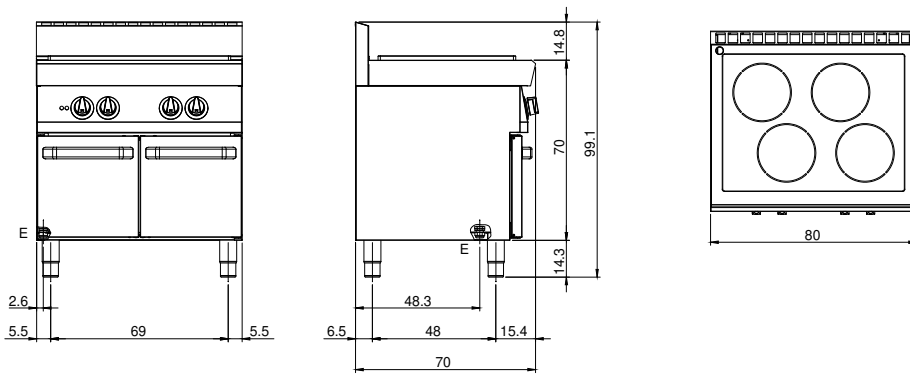

E: Electric power