



Client _____ Quantity _____
Project _____ Position _____

ROC 900

Model: R90/120CFGEB

Cod: MP01034134052

Technical data

Modularity:	Electric oven
Dimension (mm):	1200x900x870
Oven dimension (mm):	555x660x257
Total electric power (kW):	6
Total gas power (Kcal/h):	31815
Total gas power (kW):	37
Oven type:	Static oven
Oven power (kW):	6
Oven temperature range (°C):	50-300
Gas connection:	1/2"
Electric power (V):	380-415
Ampere (A):	14
Phases:	3N
Cable section (mmq):	5G1,5
Frequency (Hz):	50-60
Net volume (m3):	0,94
Packing dimensions (mm):	1280x1026x1109
Gross weight (kg):	186,6
Burner power 1 (kW):	5,5
Burner power 2 (kW):	7,5
Burner power 3 (kW):	5,5
Burner power 4 (kW):	5,5
Burner power 5 (kW):	5,5
Burner power 6 (kW):	7,5
Gross volume (m3):	1,456

Features

Burners:	Single and double crown cast iron burners with brass burner cap
Grill:	For single burner in cast iron or stainless steel (optional) dishwasher safe
Working top:	Made of AISI 304 stainless steel with a thickness of 20/10 mm and enamelled containers
Knobs:	Made of aluminum with IPX5 water protection
Handles:	The brushed aluminum handles allow for a secure and sturdy grip with a ergonomic lines
Flue:	Removable made of cast iron
Kit Gas:	Natural gas conversion kit 30/50 m/bar (tested with natural gas G20)

Technical draw

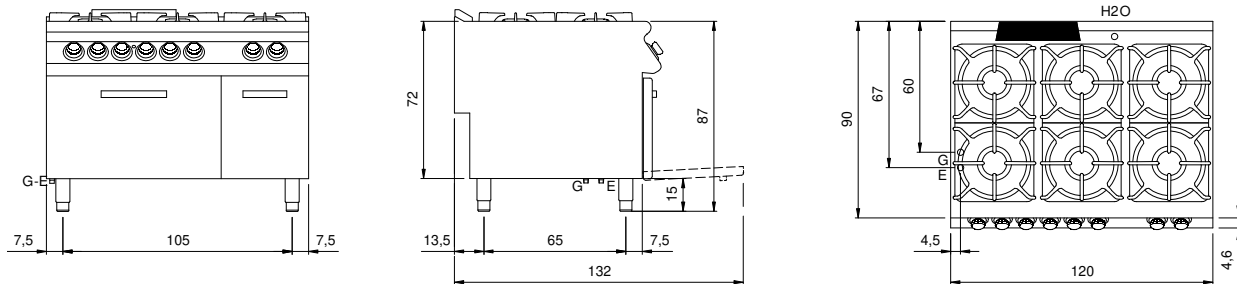

G: Gas connection 1/2"

E: Electric power