



Client _____ Quantity _____
Project _____ Position _____

ROC 700

Model: R70/120CFGEB

Cod: MP01034133051

Technical data

| | |
|------------------------------|---------------|
| Modularity: | Electric oven |
| Dimension (mm): | 1200x730x870 |
| Oven dimension (mm): | 555x660x289 |
| Total electric power (kW): | 6 |
| Total gas power (Kcal/h): | 22186 |
| Total gas power (kW): | 25,8 |
| Oven type: | Static oven |
| Oven power (kW): | 6 |
| Oven temperature range (°C): | 50-300 |
| Gas connection: | 1/2" |
| Electric power (V): | 380-415 |
| Ampere (A): | 14 |
| Phases: | 3N |
| Cable section (mmq): | 5G1,5 |
| Frequency (Hz): | 50-60 |
| Net volume (m3): | 0,762 |
| Packing dimensions (mm): | 1280x856x1109 |
| Gross weight (kg): | 173,1 |
| Burner power 1 (kW): | 5,5 |
| Burner power 2 (kW): | 3,7 |
| Burner power 3 (kW): | 3,7 |
| Burner power 4 (kW): | 3,7 |
| Burner power 5 (kW): | 5,5 |
| Burner power 6 (kW): | 3,7 |
| Gross volume (m3): | 1,215 |

Features

| | |
|--------------|--|
| Burners: | Single and double crown cast iron burners with brass burner cap |
| Grill: | For single burner in cast iron or stainless steel (optional) dishwasher safe |
| Working top: | Made of AISI 304 stainless steel with a thickness of 20/10 mm and enamelled containers |
| Knobs: | Made of aluminum with IPX5 water protection |
| Handles: | The brushed aluminum handles allow for a secure and sturdy grip with a ergonomic lines |
| Flue: | Removable gas exhaust flue grill made of cast iron |
| Kit Gas: | Natural gas conversion kit 30/50 m/bar (tested with natural gas G20) |

Technical draw

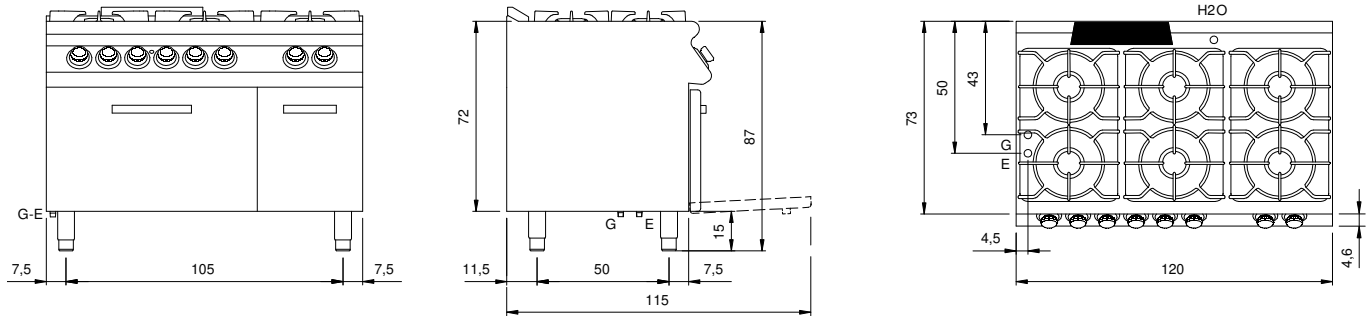

G: Gas connection 1/2"

E: Electric power