



Client _____ Quantity _____

Project _____ Position _____

FUN 600

Model: F60/90CFGE

Cod: MP01032131001

Technical data

Modularity:	Top
Dimension (mm):	900x600x850
Oven dimension (mm):	570x340x325
Total electric power (kW):	3
Total gas power (Kcal/h):	14962
Total gas power (kW):	17,4
Oven type:	Electric convection oven
Oven power (kW):	3
Oven temperature range (°C):	50-300
Gas connection:	1/2"
Electric power (V):	220-240
Ampere (A):	14
Phases:	1
Cable section (mmq):	3G2,5
Frequency (Hz):	50-60
Net volume (m3):	0,459
Packing dimensions (mm):	976x695x1170
Gross weight (kg):	86
Burner power 1 (kW):	3,6
Burner power 2 (kW):	3,3
Burner power 3 (kW):	3,3
Burner power 4 (kW):	3,6
Burner power 5 (kW):	3,6
Gross volume (m3):	0,794

Features

Burners:	Piezo ignition available in double or single crown
Grill:	Removable enamelled container for cleaning
Working top:	Made of AISI 304 stainless steel with a thickness of 8/10 mm
Knobs:	Knobs are made from a sturdy heat-resistant polymer blend
Handles:	Brushed aluminum finish
Flue:	Made in a single piece, which facilitates the alignment of the modules
Kit Gas:	Natural gas conversion kit 30/50 m/bar (tested with natural gas G20)

Gas range, 5 burners with electric convection oven Top with deep funnel in AISI 304 stainless steel; covering in AISI 430 stainless steel thickness 8/10; bottoms and internal parts in anti-corrosion material (aluminised sheet metal). Equipped with high power triple ring rapid burners. Safety gas valve cocks with thermocouple. Piezoelectric burner ignition 5 burners (2x3,3 kW + 3x3,6 kW) - hob total power 17.4 kW. Pan supports for hobs in acid-resistant enamelled steel Oven in enamelled steel with double wall insulated door and equipped with balancing springs. The thermally insulated chamber is equipped with side rack supports that make it possible to insert pans in 4 positions. Forced convection operation by means a motor with a stainless steel fan rotor. Heating is by means of a thermostat-controlled heating element with temperature adjustment from 100 to 300°C + 1 grill heating element. The oven is equipped with a main switch, thermostat, indicator lights to show proper operation, chamber illumination light. Equipped with 1 rack 445x350 mm. 1 drip pan 445x350x30h. mm. Total gas power 17.4 kW - Total electric power 3 kW. Electrical power supply VAC 230+1 50÷60 Hz.

Technical draw

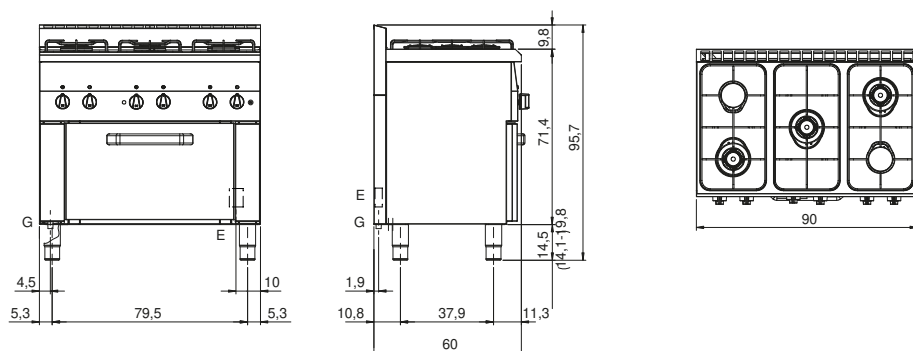

G: Gas connection 1/2"

E: Electric power