



Client _____ Quantity _____
 Project _____ Position _____

FUN 650

Model: F65/110CFGB

Cod: MP01032112001

Technical data

Modularity:	Gas oven
Dimensions (mm):	1100x650x850
Oven dimension (mm):	555x540x270
Total gas power (Kcal/h):	26484
Total gas power (kW):	30,8
Oven type:	Static oven
Oven power (kW):	5
Oven temperature range (°C):	150-300
Gas connection:	1/2"
Net volume (m3):	0,608
Packing dimensions (mm):	1176x776x1180
Gross weight (kg):	124
Burner power 1 (kW):	5
Burner power 2 (kW):	3,6
Burner power 3 (kW):	5
Burner power 4 (kW):	3,6
Burner power 5 (kW):	5
Burner power 6 (kW):	3,6
Gross volume (m3):	1,077

Features

Burners:	Piezo ignition available in cast iron with single crown brass burner cap
Grill:	In cast iron with long spokes
Working top:	Made of AISI 304 stainless steel with a thickness of 10/10 mm and removable enamelled containers
Knobs:	Knobs are made from a sturdy heat-resistant polymer blend and are equipped with liquid anti-leakage washer
Handles:	Brushed aluminum finish
Kit Gas:	Natural gas conversion kit 30/50 m/bar (tested with natural gas G20)

Gas range, 4 burners with electric convection oven Top with deep funnel in AISI 304 stainless steel; covering in AISI 430 stainless steel thickness 8/10; bottoms and internal parts in anti-corrosion material (aluminised sheet metal). Equipped with high power triple ring rapid burners. Safety gas valve cocks with thermocouple. Piezoelectric burner ignition 4 burners (2x3.3 kW + 2x3.6 kW) - hob total power 13.8 kW. Pan supports for hobs in acid-resistant enamelled steel Oven in enamelled steel with double wall insulated door and equipped with balancing springs. The thermally insulated chamber is equipped with side rack supports that make it possible to insert pans in 4 positions. Forced convection operation by means a motor with a stainless steel fan rotor. Heating is by means of a thermostat-controlled heating element with temperature adjustment from 50 to 300°C + 1 grill heating element. The oven is equipped with a main switch, thermostat, indicator lights to show proper operation, chamber illumination light. Equipped with 1 rack 445x350 mm. 1 drip pan 445x350x30h. mm. Total gas power 12.2 kW Total electric power 3 kW. Electrical power supply V AC 230+1 50÷60 Hz.

Technical draw

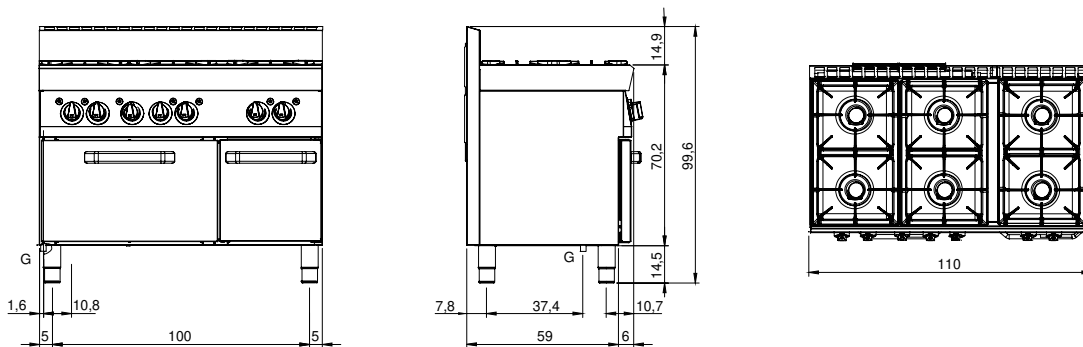

G: Gas connection 1/2"