



Client _____ Quantity _____

Project _____ Position _____

ROC 900

Model: R90/80PCEQ/A

Cod: MP01014124005

Technical data

| | |
|----------------------------|-----------------|
| Modularity: | On open cabinet |
| Dimension (mm): | 800x900x870 |
| Total electric power (kW): | 16 |
| Electric power (V): | 380-415 |
| Ampere (A): | 36,5 |
| Phases: | 3N |
| Cable section (mmq): | 5G6 |
| Frequency (Hz): | 50-60 |
| Net volume (m3): | 0,626 |
| Packing dimensions (mm): | 880x1026x1109 |
| Gross weight (kg): | 103 |
| Gross volume (m3): | 1,001 |

Features

| | |
|--------------|---|
| Working top: | Made of AISI 304 stainless steel with a thickness of 20/10 mm |
| Knobs: | Made of aluminum with IPX5 water protection |
| Flue: | Removable made of cast iron |

Electric hob with 4 plates, model on open cabinet. Side panels, bottom and back made in stainless steel. Pressed top made in AISI 304 thickness 20/10 with control edge for liquid collection. Rear flue made in enamelled cast-iron. N° 4 square electric plates 300x300 mm each with 4 kW, equipped with safety thermostat and automatic recovery. 6 levels temperature control for each plate. Lamps on control panel to indicate the activation of electric supply and plates operation. Special design knobs to avoid water penetration in the control panel. Base completely made in stainless steel. Adjustable feet made in stainless steel. IPX5 protection rating. Electric power supply VAC 400 3N 50÷60 Hz - 16 kW.

Technical draw

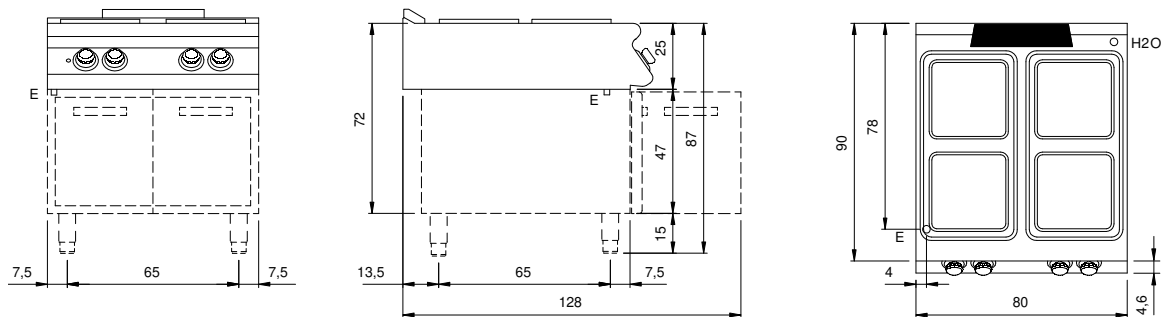

E: Electric power