



Client _____ Quantity _____

Project _____ Position _____

ROC 900

Model: R90/40PCEQ/A

Cod: MP01014124002

Technical data

Modularity:	On open cabinet
Dimension (mm):	400x900x870
Total electric power (kW):	8
Electric power (V):	380-415
Ampere (A):	18,5
Phases:	3N
Cable section (mmq):	5G2,5
Frequency (Hz):	50-60
Net volume (m3):	0,313
Packing dimensions (mm):	480x1026x1075
Gross weight (kg):	102
Gross volume (m3):	0,529

Features

Working top:	Made of AISI 304 stainless steel with a thickness of 20/10 mm
Knobs:	Made of aluminum with IPX5 water protection
Flue:	Removable made of cast iron

Technical draw

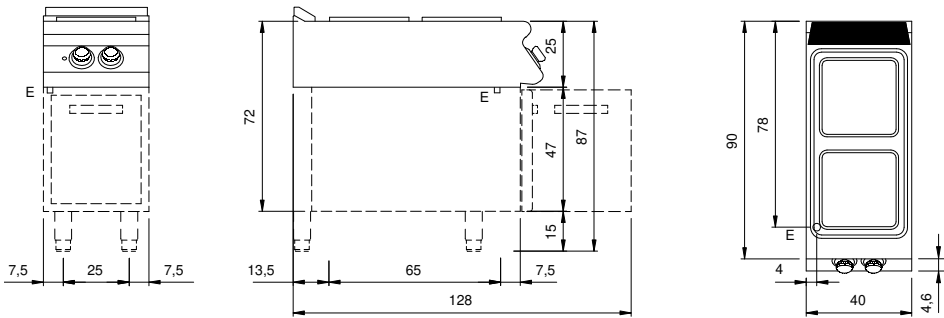

E: Electric power