



Client _____ Quantity _____
Project _____ Position _____

ROC 700

Model: R70/40PCE/P

Cod: MP01014123003

Technical data

Modularity:	On cabinet with door
Dimension (mm):	400x730x870
Total electric power (kW):	5,2
Electric power (V):	380-415
Ampere (A):	12
Phases:	3N
Cable section (mmq):	5G1,5
Frequency (Hz):	50-60
Net volume (m3):	0,254
Packing dimensions (mm):	480x856x1075
Gross weight (kg):	50,6
Gross volume (m3):	0,442

Features

Working top:	Made of AISI 304 stainless steel with a thickness of 20/10 mm
Knobs:	Made of aluminum with IPX5 water protection
Handles:	The brushed aluminum handles allow for a secure and sturdy grip with a ergonomic lines
Flue:	Removable gas exhaust flue grill made of cast iron

Electric hob with 2 round plates, model on counter with door. Side panels, bottom and back made in stainless steel. Pressed top made in AISI 304 thickness 20/10 with control edge for liquid collection designed for flush alignment. Rear flue made in enamelled cast-iron. N° 2 round electric plates diam. 220 mm each with 2.6 kW, equipped with safety thermostat and automatic recovery. 6 levels temperature control for each plate. Lamp on control panel to indicate the activation of electric supply and plates operation. Special design knobs to avoid water penetration in the control panel. Base completely made in stainless steel. Pressed hinged door. Ergonomic handle. Adjustable feet made in stainless steel. IPX5 protection rating. Electric power supply VAC 400 3N 50÷60 Hz - 5.2 kW.

Technical draw

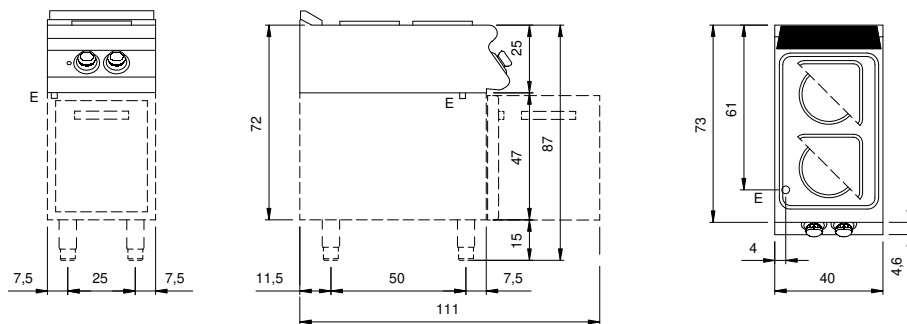

E: Electric power