



Client _____ Quantity _____
Project _____ Position _____

ROC 700

Model: R70/80PCGB/P

Cod: MP01014113055

Technical data

| | |
|---------------------------|-----------------------|
| Modularity: | On cabinet with doors |
| Dimension (mm): | 800x730x870 |
| Total gas power (Kcal/h): | 15822 |
| Total gas power (kW): | 18,4 |
| Gas connection: | 1/2" |
| Net volume (m3): | 0,508 |
| Packing dimensions (mm): | 880x856x1109 |
| Gross weight (kg): | 91,6 |
| Burner power 1 (kW): | 5,5 |
| Burner power 2 (kW): | 3,7 |
| Burner power 3 (kW): | 5,5 |
| Burner power 4 (kW): | 3,7 |
| Gross volume (m3): | 0,835 |

Features

| | |
|--------------|--|
| Burners: | Single and double crown cast iron burners with brass burner cap |
| Grill: | For single burner in cast iron or stainless steel (optional) dishwasher safe |
| Working top: | Made of AISI 304 stainless steel with a thickness of 20/10 mm and enamelled containers |
| Knobs: | Made of aluminum with IPX5 water protection |
| Handles: | The brushed aluminum handles allow for a secure and sturdy grip with a ergonomic lines |
| Flue: | Removable gas exhaust flue grill made of cast iron |
| Kit Gas: | Natural gas conversion kit 30/50 m/bar (tested with natural gas G20) |

Gas boiling unit with 4 burners, model on cabinet with doors. Side panels, bottom and back made of stainless steel. Top made of AISI 304 thickness 20/10 designed for flush alignment. Gas supply by safety taps with thermocouple and pilot burner for the automatic ignition of main burner. Radiused corners top, easy to clean, equipped with enamelled cast-iron hobs resistant to acid, alkali and flame. Equipped with high-power cast iron/brass rapid burners with containers in enamelled steel that can be extracted for easy cleaning. nr.2 burners 5.5 kW and nr.2 burners 3.7 kW. Special design knobs to avoid water penetration in the control panel. Base completely made of stainless steel. Door with stainless steel tubular handle. Adjustable feet made of stainless steel. IPX5 protection rating. Gas total power 18.4 kW.

Technical draw

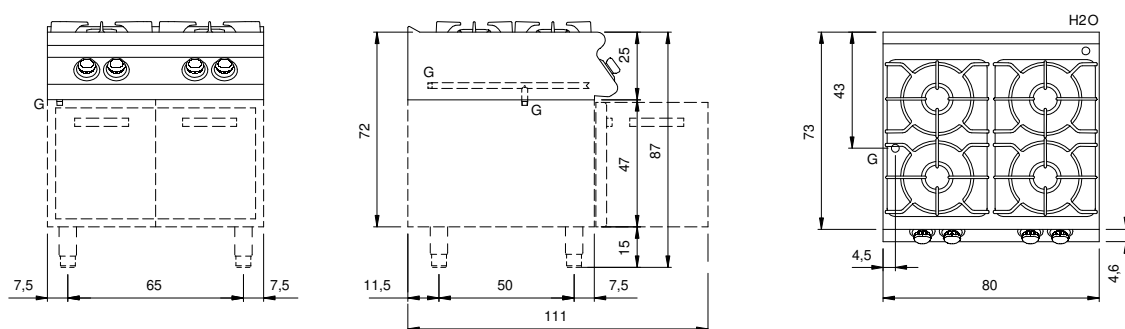

G: Gas connection 1/2"