



Client _____ Quantity _____
Project _____ Position _____

ROC 700

Model: R70/120PCG/P

Cod: MP01014113008

Technical data

Modularity:	On cabinet with doors
Dimension (mm):	1200x730x870
Total gas power (Kcal/h):	28805
Total gas power (kW):	33,5
Gas connection:	1/2"
Net volume (m3):	0,762
Packing dimensions (mm):	1280x856x1109
Gross weight (kg):	126,1
Burner power 1 (kW):	3,5
Burner power 2 (kW):	6
Burner power 3 (kW):	6
Burner power 4 (kW):	6
Burner power 5 (kW):	6
Burner power 6 (kW):	6
Gross volume (m3):	1,215

Features

Burners:	Single and double crown cast iron burners with brass burner cap
Grill:	For single burner in cast iron or stainless steel (optional) dishwasher safe
Working top:	Pressed top made of AISI 304 stainless steel 20/10 mm thick
Knobs:	Made of aluminum with IPX5 water protection
Handles:	The brushed aluminum handles allow for a secure and sturdy grip with a ergonomic lines
Flue:	Removable gas exhaust flue grill made of cast iron
Kit Gas:	Natural gas conversion kit 30/50 m/bar (tested with natural gas G20)

Gas boiling unit with 6 burners, model on counter with doors. Side panels, bottom and back made in stainless steel. Pressed top made in AISI 304 thickness 20/10 designed for flush alignment. Gas supply by safety taps with thermocouple and pilot burner for the automatic ignition of main burner. Radiused corners top, easy to clean, equipped with high thick enamelled cast-iron hobs resistant to acid, alkali and flame. Rapid burners made in cast iron and brass sealed to the top, nr. 4 burner 6 kW and nr.2 burner 3.5 kW. (Available burner powers 3,5 kW, 6 kW). Special design knobs to avoid water penetration in the control panel. Base completely made in stainless steel. Presses hinged doors. Ergonomic handle. Adjustable feet made in stainless steel. IPX5 protection rating. Gas total power 33.5 kW.

Technical draw

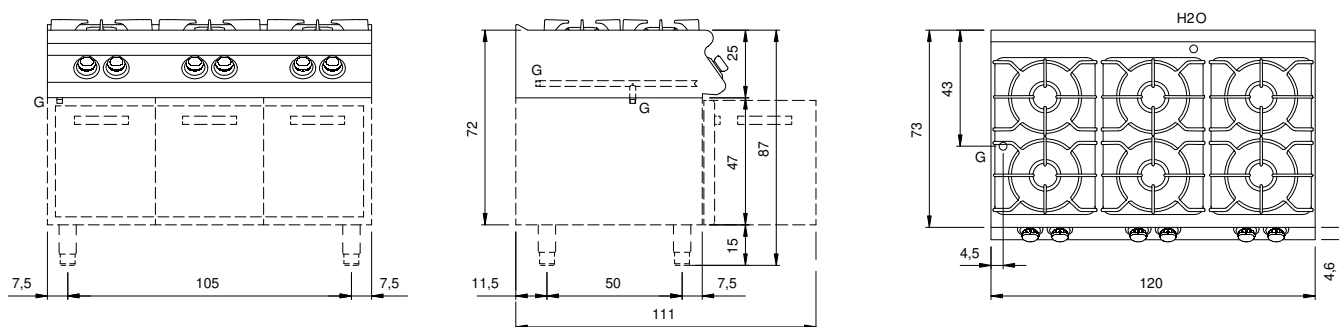

G: Gas connection 1/2"