

Client _____ Quantity _____
Project _____ Position _____

ROC 700

Model: R70/80PCG/T

Cod: MP01014113003



Technical data

Modularity:	Top
Dimension (mm):	800x730x280
Total gas power (Kcal/h):	18487
Total gas power (kW):	21,5
Gas connection:	1/2"
Net volume (m3):	0,164
Packing dimensions (mm):	880x856x509
Gross weight (kg):	73
Burner power 1 (kW):	3,5
Burner power 2 (kW):	6
Burner power 3 (kW):	6
Burner power 4 (kW):	6
Gross volume (m3):	0,383

Features

Burners:	Single and double crown cast iron burners with brass burner cap
Grill:	For single burner in cast iron or stainless steel (optional) dishwasher safe
Working top:	Pressed top made of AISI 304 stainless steel 20/10 mm thick
Knobs:	Made of aluminum with IPX5 water protection
Flue:	Removable gas exhaust flue grill made of cast iron
Kit Gas:	Natural gas conversion kit 30/50 m/bar (tested with natural gas G20)

Gas boiling unit with 4 burners, counter top model. Side panels, bottom and back made in stainless steel. Pressed top made in AISI 304 thickness 20/10 designed for flush alignment. Gas supply by safety taps with thermocouple and pilot burner for the automatic ignition of main burner. Radiused corners top, easy to clean, equipped with high thick enamelled cast-iron hobs resistant to acid, alkali and flame. Rapid burners made in cast iron and brass sealed to the top, nr.3 burner 6 kW and nr.1 burner 3.5 kW. (Available burner powers 3,5 kW, 6 kW). Special design knobs to avoid water penetration in the control panel. Adjustable feet. IPX5 protection rating. Gas total power 21.5 kW.

Technical draw

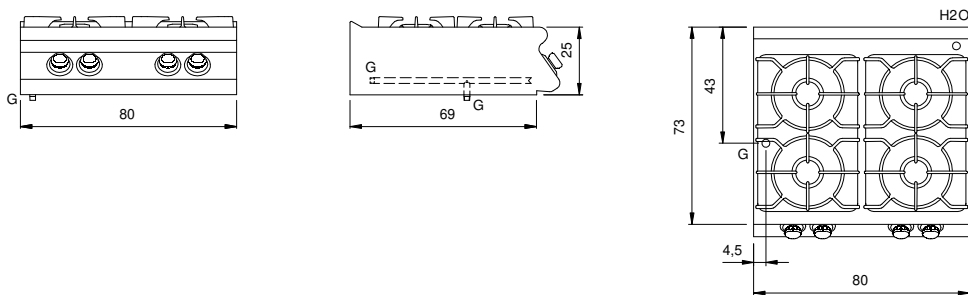

G: Gas connection 1/2"