



Client \_\_\_\_\_ Quantity \_\_\_\_\_  
Project \_\_\_\_\_ Position \_\_\_\_\_

## ROC 700

Model: R70/40PCG/A

Cod: MP01014113001

### Technical data

|                           |                 |
|---------------------------|-----------------|
| Modularity:               | On open cabinet |
| Dimension (mm):           | 400x730x870     |
| Total gas power (Kcal/h): | 8169            |
| Total gas power (kW):     | 9,5             |
| Gas connection:           | 1/2"            |
| Net volume (m3):          | 0,254           |
| Packing dimensions (mm):  | 480x856x1075    |
| Gross weight (kg):        | 64              |
| Burner power 1 (kW):      | 3,5             |
| Burner power 2 (kW):      | 6               |
| Gross volume (m3):        | 0,442           |

### Features

|              |  |
|--------------|--|
| Burners:     | Single and double crown cast iron burners with brass burner cap              |
| Grill:       | For single burner in cast iron or stainless steel (optional) dishwasher safe |
| Working top: | Pressed top made of AISI 304 stainless steel 20/10 mm thick                  |
| Knobs:       | Made of aluminum with IPX5 water protection                                  |
| Flue:        | Removable gas exhaust flue grill made of cast iron                           |
| Kit Gas:     | Natural gas conversion kit 30/50 m/bar (tested with natural gas G20)         |

Gas boiling unit with 2 burners, model on open counter. Side panels, bottom and back made in stainless steel. Pressed top made in AISI 304 thickness 20/10 designed for flush alignment. Gas supply by safety taps with thermocouple and pilot burner for the automatic ignition of main burner. Radiused corners top, easy to clean, equipped with high thick enamelled cast-iron hobs resistant to acid, alkali and flame. Rapid burners made in cast iron and brass sealed to the top, nr.1 burner 6 kW and nr.1 burner 3.5 kW. (Available burner powers 3,5 kW, 6 kW). Special design knobs to avoid water penetration in the control panel. Base completely made in stainless steel. Adjustable feet made in stainless steel. IPX5 protection rating. Gas total power 9.5 kW.

## Technical draw

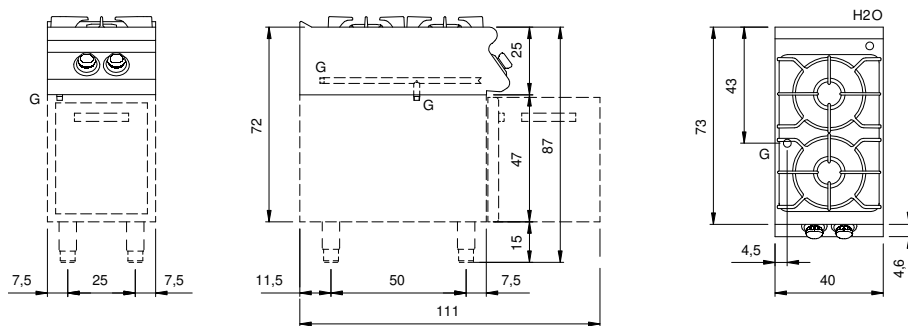

G: Gas connection 1/2"