

Client _____ Quantity _____
 Project _____ Position _____

FUN 700

Model: F70/40PCGB/T

Cod: MP01012113002



Technical data

Modularity:	Top
Dimensions (mm):	400x700x300
Total gas power (Kcal/h):	7911
Total gas power (kW):	9,2
Gas connection:	1/2"
Net volume (m3):	0,084
Packing dimensions (mm):	477x776x612
Gross weight (kg):	29
Burner power 1 (kW):	5,5
Burner power 2 (kW):	3,7
Gross volume (m3):	0,227

Features

Burners:	Double or single crown cast iron version available with a pilot light
Grill:	Cast-iron with brass single- and double-crown burner with pilot
Working top:	Made of AISI 304 stainless steel with a thickness of 10/10 mm and removable enamelled containers
Knobs:	Knobs are made from a sturdy heat-resistant polymer blend and are equipped with liquid anti-leakage washer
Kit Gas:	Natural gas conversion kit 30/50 m/bar (tested with natural gas G20)

Electric hob with 4 plates Top with deep funnel in AISI 304 stainless steel; covering in AISI 430 stainless steel thickness 8/10; bottoms and internal parts in anti-corrosion material (aluminised sheet metal). Hob with cast iron electric plates Ø 180 mm with stainless steel edge sealed to top. Six different temperature adjustments for each plate. Indicator lights to show electrical power supplied and plates in operation. Power: 4 plates x 2 kW ea. Total power 8 kW. Electrical power supply V AC 400+3N 50÷60 Hz.

Technical draw

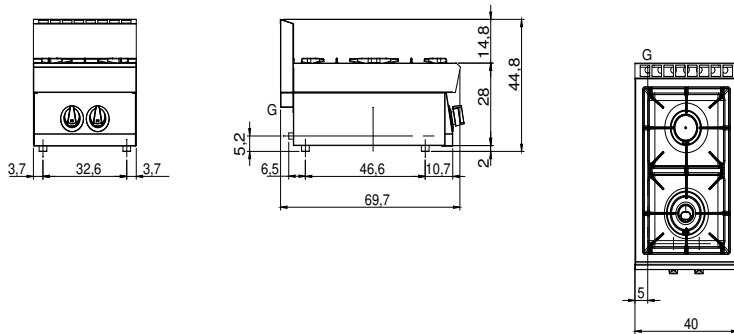

G: Gas connection 1/2"