



Client _____ Quantity _____
Project _____ Position _____

ROC 900

Model: R90/80CPGG/2V40/P

Cod: MP01214114022

Technical data

Modularity:	On cabinet with door
Dimensions (mm):	800x900x870
Total gas power (Kcal/h):	18917
Total gas power (kW):	22
Nr. Wells:	2
Well litres 1:	40
Well litres 2:	40
Well dimensions 1 (mm):	306x508x316
Well dimensions 2 (mm):	306x508x316
Gas connection:	1/2"
Cold water inflow:	3/4" + 3/4"
Cold water pressure (bar):	Max pressure 5 bar
Drain size:	1" + 1"
Net volume (m3):	0,626
Packing dimensions (mm):	880x1026x1109
Gross weight (kg):	119,1
Gross volume (m3):	1,001

Features

Working top:	Made of AISI 304 stainless steel with a thickness of 20/10 mm
Knobs:	Made of aluminum with IPX5 water protection
Flue:	Removable made of cast iron
Water inflow:	With tap
Kit Gas:	Natural gas conversion kit 30/50 m/bar (tested with natural gas G20)

Full-gas pasta cooker, double tank, 40-liter capacity. Sides, bottom and rear panel in stainless steel. Worktop in AISI 304 stainless steel, 2 mm thick, stamped with overflow-prevention recess. Rear chimney in enameled cast iron; designed for head-to-head installation. Tanks stamped in polished AISI 316 stainless steel with radiused bottom. Water filling via manual valve operated by knob on the front control panel. Filling pressure switch prevents heating when the tank is empty. Option for initial or recovery rapid filling. Fixed stainless steel water dispenser located under the draining top. Heating via stainless steel burners with stabilized flame, pilot burner and safety thermocouple. Ignition by piezoelectric device. Heating adjustable via gas valve. Water discharge via tap located inside the base. Labyrinth-type control knobs prevent water ingress during cleaning operations. Unit equipped with height-adjustable stainless steel feet. Baskets not included. Protection rating IPX5. Total gas power 23.6 kW.

Technical draw

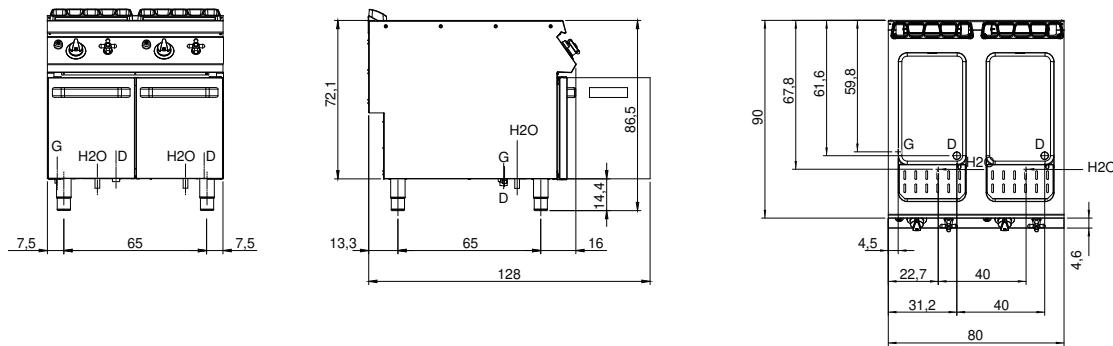

G: Gas connection 1/2"

D: Drain for water

H2O: Water inflow 3/4"