



Client _____ Quantity _____
Project _____ Position _____

ROC 900

Model: R90/40INDC/P

Cod: MP01134124122

Technical data

Modularity:	On cabinet with doors
Dimensions (mm):	400x900x870
Total electric power (kW):	10
Electric power (V):	380-415
Ampere (A):	15,5
Phases:	3N
Cable section (mmq):	5G2,5
Frequency (Hz):	50-60
Net volume (m3):	0,313
Packing dimensions (mm):	480x1026x1075
Gross weight (kg):	66
Gross volume (m3):	0,529

Features

Working top:	Made of AISI 304 stainless steel with a thickness of 20/10 mm
Knobs:	Made of aluminum with IPX5 water protection
Handles:	The brushed aluminum handles allow for a secure and sturdy grip with a ergonomic lines
Flue:	Removable made of cast iron

Electric full-coverage induction cooking top on cupboard with doors. Sides, bottom and rear panel in stainless steel. Cooking surface in glass-ceramic, hermetically sealed to the top. Heating is activated by a pot detection system when cookware is placed on the surface. Indicator lamp shows heating activation and correct appliance operation. Unit designed for head-to-head joint installation. Labyrinth-type control knobs prevent water ingress during cleaning operations. Base entirely made of stainless steel. Hinged door with ergonomic handle. Height-adjustable stainless steel feet. Protection rating IPX5. Electrical supply 400 VAC 3N 50/60 Hz – 10 kW.

Technical draw

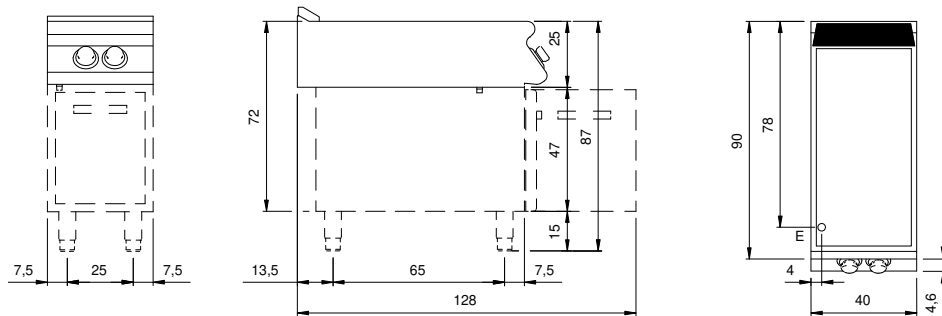

E: Electric power