



Client _____ Quantity _____

Project _____ Position _____

ROC 1100

Model: R110/100INDC/A

Cod: MP01135125123

Technical data

Modularity:	On open cabinet
Dimensions (mm):	1000x1100x870
Total electric power (kW):	20
Electric power (V):	380-415
Ampere (A):	30,5
Phases:	3N
Cable section (mmq):	5G6
Frequency (Hz):	50-60
Net volume (m3):	0,957
Packing dimensions (mm):	1280x1272x1274
Gross weight (kg):	128
Gross volume (m3):	2,074

Features

Working top:	Made of AISI 304 stainless steel with a thickness of 2 mm
Knobs:	Made of aluminum with IPX5 water protection

Electric full-coverage induction cooking top on open base. Side panels, bottom and rear panel in stainless steel. Cooking surface in glass-ceramic hermetically sealed to the top. Heating activated through a pan-detection system when cookware is placed on the surface. Indicator light to show heating activation and correct appliance operation. Suitable for head-to-head joint installation. Labyrinth-type control knobs preventing water infiltration during cleaning operations on both sides. Base entirely made of stainless steel. Height-adjustable stainless-steel feet. Protection rating IPX5. Electrical supply 400 VAC 3N 50/60 Hz – 20 kW.

Technical draw

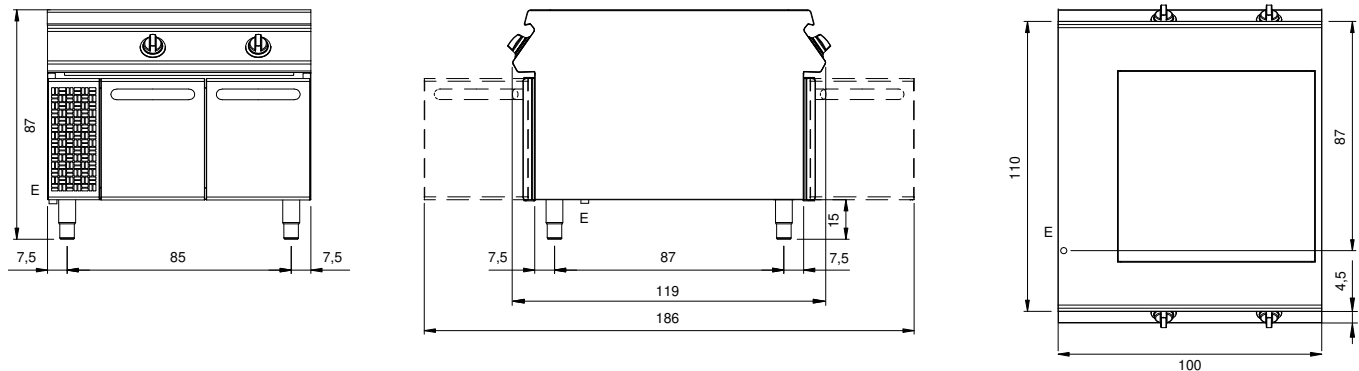

E: Electric power