



Client _____ Quantity _____
Project _____ Position _____

ROC 900

Model: R90/40FTG/SR/A

Cod: MP01374114030

Technical data

Modularity:	On open cabinet
Dimension (mm):	400x900x870
Total gas power (Kcal/h):	9029
Total gas power (kW):	10,5
Cooking zone dimensions 1 (LxD mm):	335x700
Gas connection:	1/2"
Net volume (m3):	0,313
Packing dimensions (mm):	480x1026x1075
Gross weight (kg):	63,5
Gross volume (m3):	0,529

Features

Working top:	Made of AISI 304 stainless steel with a thickness of 20/10 mm
Material of plate:	Satin chrome
Plate finish:	Ribbed
Knobs:	Made of aluminum with IPX5 water protection
Liquid collection container:	Removable and dishwasher safe
Plate:	Satin chrome plate
Upright Splash guard:	On two sides (optional)
Kit Gas:	Natural gas conversion kit 30/50 m/bar (tested with natural gas G20)

Gas griddle with satin chrome grooved plate, model on open cabinet. Side panels, bottom and back made in stainless steel. Top made in AISI 304 thickness 20/10. Rear flue made in enamelled cast-iron. designed for flush alignment. Recessed (4 cm) hotplate fully welded and sealed to the top. Hard chrome plated hotplate with mirror polished surface with cold zone at the front. Round hole and extractable drawer for grease drain and collection. Plate dim.335x700 mm. Heating by means of steel burner with stabilized flame complete with pilot flame and safety thermocouple. Gas supply by means of thermostatic valve. Temperature control by thermostat. Automatic ignition by means of piezoelectric device with waterproof cap. Special design knobs to avoid water penetration in the control panel. Base completely made in stainless steel. Adjustable feet made in stainless steel. IPX5 protection rating. Gas total power 10,5 kW.

Technical draw

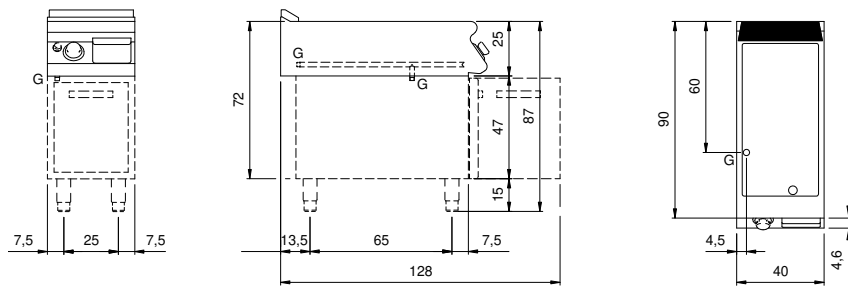

G: Gas connection 1/2"