



Client \_\_\_\_\_ Quantity \_\_\_\_\_  
Project \_\_\_\_\_ Position \_\_\_\_\_

## ROC 700

Model: R70/40FTG/SR/P

Cod: MP01374113030

### Technical data

Modularity:	On cabinet with door
Dimension (mm):	400x730x870
Total gas power (Kcal/h):	6019
Total gas power (kW):	7
Cooking zone dimensions 1 (LxD mm):	335x530
Gas connection:	1/2"
Net volume (m3):	0,254
Packing dimensions (mm):	480x856x1075
Gross weight (kg):	68,3
Gross volume (m3):	0,442

### Features

Working top:	Made of AISI 304 stainless steel with a thickness of 20/10 mm
Material of plate:	Satin chrome
Plate finish:	Ribbed
Knobs:	Made of aluminum with IPX5 water protection
Handles:	The brushed aluminum handles allow for a secure and sturdy grip with a ergonomic lines
Flue:	Removable gas exhaust flue grill made of cast iron
Liquid collection container:	Estraibile e lavabile in lavastoviglie
Plate:	Satin chrome plate
Upright Splash guard:	On two sides (optional)
Kit Gas:	Natural gas conversion kit 30/50 m/bar (tested with natural gas G20)

## Technical draw

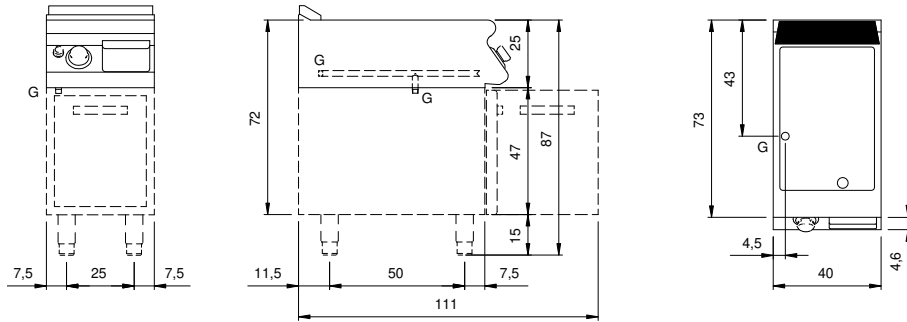

G: Gas connection 1/2"